



SOLD

A MUST FOR YOUR PROPERTY PORTFOLIO!

Resort-Style Townhouse living in Prime Location

Discover the perfect blend of comfort and convenience with this well-maintained 3-bedroom townhouse. Situated in a premium location and backing onto beautiful bush surroundings, this townhouse complex offers the best of both worlds. Just a short walk to Morayfield Shopping Centre, Morayfield State School, Morayfield Train Station and two local childcare centres, it's also only a 5-minute drive to the local train station and a 10-minute drive to the Bruce Highway. This property is an ideal investment opportunity with solid profit potential and lovely, stable tenants already in place.

Property Features:

Ground Floor:

- * Open-plan living, dining, and kitchen area
- * Air-conditioned living areas
- * Separate toilet
- * Sliding door access to an outdoor undercover patio/entertaining area

Upper Floor:

- 3 spacious bedrooms with ceiling fans
- A/C Master bedroom with ensuite, walk-in wardrobe, and private balcony
- 2 additional bedrooms with built-in wardrobes
- Spacious main bathroom with bath and shower

Additional Features:

- * Modern kitchen with ample cupboard space, electric stove, and dishwasher
- * Separate laundry next to the kitchen with good storage
- * Security screens
- * Single auto remote lock-up garage with internal access
- * Outdoor patio entertaining area
- * Very large fully fenced backyard with lush reserve views, no rear neighbour
- * Low-maintenance gardens
- * NBN connection
- * Resort-style pool and gym
- * Secure gated & CCTV system

3 BED | 2 BATH | 1 CAR

PRICE:

\$534,000

OPEN FOR INSPECTION:

N/A



Mal Lucas
0429535197

mal@atrealty.com.au

www.atrealty.com.au

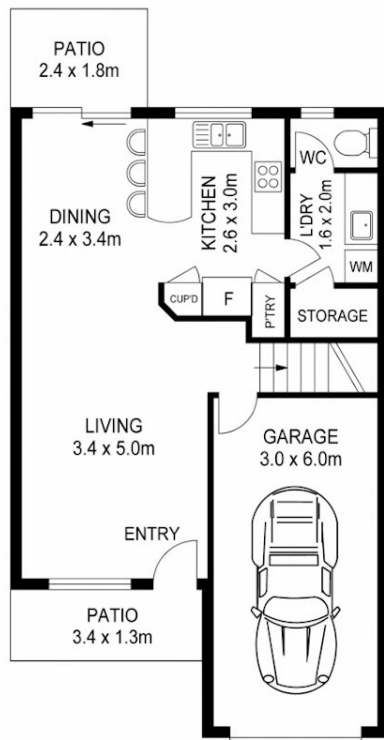

GROUND FLOOR

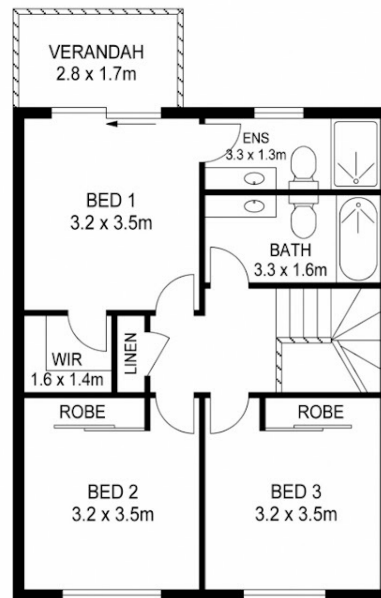

FIRST FLOOR

APPROX FLOOR AREA : 138m²



For illustrative purposes only. Not an engineering plan.

Whilst all effort is taken to be correct, this plan may contain inaccuracies or omissions and should be used only as a guide. No representations are made as to the condition, operability or legal status of anything depicted.

Disclaimer: Please note this floor plan is for marketing purposes and is to be used as a guide only. All dimensions are estimates only and may not be exact measurements.