



**SOLD**

## STYLISH AND SPACIOUS APARTMENT ON THE WATERS EDGE

THIS APARTMENT WILL SELL QUICK - ENQUIRE TODAY!

Welcome to 42/22 Jennifer Avenue, a beautifully presented two-bedroom, two-bathroom apartment nestled in the heart of Runaway Bay. Perfect for downsizers, investors, or first-home buyers, this residence offers a blend of comfort, convenience, and modern living in a highly sought-after location.

As you step inside, you're greeted by an open-plan living and dining area that flows seamlessly onto a private balcony, perfect for enjoying your morning coffee or relaxing with friends. The modern kitchen is equipped with quality appliances, ample storage, and a sleek design that will inspire your inner chef.

Both bedrooms are generously sized with built-in wardrobes, with the master bedroom featuring an ensuite for added luxury. The second bathroom is conveniently located for guests and includes a shower and modern fixtures.

Residents of this complex enjoy access to a range of amenities, including a sparkling swimming pool, BBQ area, and well-maintained gardens. The property also includes secure parking and intercom access for peace of mind.

Located just moments from the Runaway Bay Shopping Centre, Broadwater, and Harbour Town, as well as schools and public transport, everything you need is right at your doorstep.

### KEY FEATURES:

- Spacious 2 bedroom, 2 Bathroom Apartment
- Brand new carpets throughout!
- Open-plan living and dining area
- Private balcony for outdoor relaxation
- Modern kitchen with quality appliances
- Master bedroom with ensuite
- Secure parking and intercom access

2 BED | 2 BATH | 1 CAR

PRICE:  
\$672,000

OPEN FOR INSPECTION:  
N/A



**Jamie Dulics**  
**0499240757**  
jamie@atrealty.com.au  
[www.atrealty.com.au](http://www.atrealty.com.au)

- 1 RESIDENCE
- 2 HARBOUR TOWN
- 3 GRIFFITH UNIVERSITY
- 4 PINE RIDGE CONSERVATION PARK
- 5 PARADISE POINT BOWLS CLUB

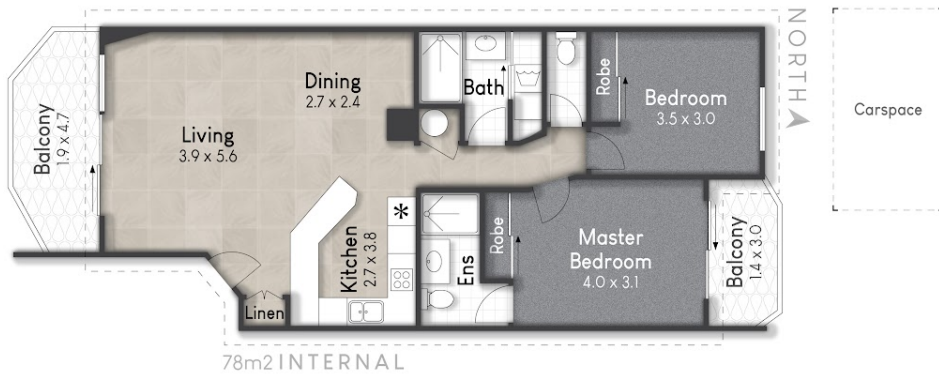

42/22 Jennifer Ave, Runaway Bay

BED 2 BATH 2 CAR 1

Internal: 78 m<sup>2</sup> | External: 12 m<sup>2</sup> | Approx Total: 90 m<sup>2</sup>



Whilst every attempt has been made to ensure the accuracy of the floor plan contained here, measurements of doors, windows, rooms and any other item are approximate and no responsibility is taken for any error, omission, or misstatement. This plan is for illustrative purposes only and should only be used as such by any prospective purchaser.



Disclaimer: Please note this floor plan is for marketing purposes and is to be used as a guide only. All dimensions are estimates only and may not be exact measurements.

**Jamie Dulics**  
 0499240757  
 jamie@atrealty.com.au  
 www.atrealty.com.au

