



**SOLD**

## RESORT STYLE LIVING IN A BOUTIQUE GATED COMPLEX

We are proud to be presenting the lucky Buyer this beautiful townhouse in a popular Boutique complex that offers it ALL. Designed for effortless living, this townhouse offers it all for the perfect Aspley lifestyle. Offering the perfect blend of style, comfort, and convenience. Works all been done and ready to move in now.

Families will love the convenience of being close to AND only a short walking distance to Aspley's retail Hub with retail business, café precinct and public transport hub and easy access at the rear of the property only for owners.

Whether you are looking for a home to get into the market, downsizing OR to add to your investment portfolio then look no further. This is definitely the one to inspect NOW!!!!. Quiet and peaceful, secluded location. Gated complex of which the majority are owner occupied. An onsite manager to maintain the complex.

A pet friendly complex subject to committee approval.

This townhouse is available for sale now and is not tenanted, so you can move in and make it your own!

Don't miss the chance to make this Townhouse your own in one of Aspley's most desirable locations!

### FEATURES INCLUDE:

#### UPPER LEVEL:

1 King size Master Bedroom with ensuite, walk in robe , Fan , AC and balcony

A further 2 bedrooms with built ins

Large Family bathroom

#### LOWER LEVEL:

Large open plan living, meals and dining areas

Dishwasher

3rd toilet / powder room

Separate laundry

Extra storage under the stairs

Outdoor fully fenced Courtyard & covered Alfresco area

Single automated Garage with a non-shared driveway and direct access into townhouse

3 BED | 2 BATH | 1 CAR

PRICE:  
\$730,000

OPEN FOR INSPECTION:  
N/A



**Beverley Gibbons**

**0420807083**

beverley.gibbons@atrealty.com.au

[www.atrealty.com.au](http://www.atrealty.com.au)

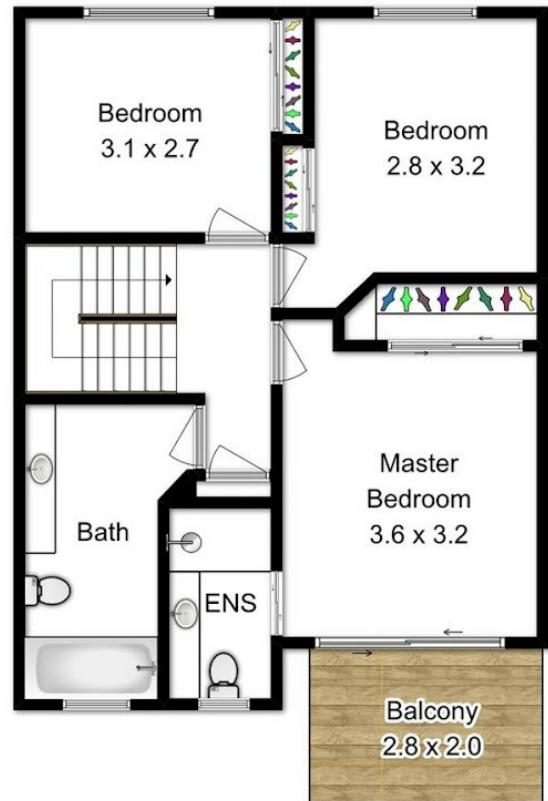

Disclaimer: Please note this floor plan is for marketing purposes and is to be used as a guide only. All dimensions are estimates only and may not be exact measurements.