



# FOR SALE

## YOUR DREAM FAMILY HOME

Welcome to this outstanding opportunity to call this immaculate property with so many features, your dream home. Featuring 4 spacious bedrooms, Bedroom 1 with ensuite. For the growing family we have 3 separate living areas. The main living area is complimented by vaulted ceilings plus an abundance of natural light.

The kitchen has stone benches, including an island bench, a stand alone electric stove with a gas cook top, walk-in pantry and dishwasher. Other additions include air conditioning with 3 split systems, ceiling fans, and gas hot water.

The 494m2 allotment provides front and backyard lush green lawns with the backyard fully fenced, Also included a garden shed (3.0 x 1.5 m) and a 5,000 litre water tank.

A special feature to this property is a 7.0 x 3.5 metre hard stand for a boat or caravan.

- \* Immaculately Presented four bedroom family home
- \* Kitchen with stone benches, gas cooktop, walk in pantry, and dishwasher
- \* Three living areas, vaulted ceilings to main living area
- \* Four good sized bedrooms with walk-in robes or built ins.
- \* Split system A/C's x 3, Ceiling fans, & gas hot water
- \* Plenty of yard space with front and back lush green lawns
- \* Property includes parking for a caravan or boat
- \* Short drive to local Schools and shops.

4 BED | 2 BATH | 2 CAR

**PRICE:**  
offers over \$895,000

**OPEN FOR INSPECTION:**  
N/A



**Simon Grayell**  
**0418708874**  
simongrayell@atrealty.com.au  
[www.atrealty.com.au](http://www.atrealty.com.au)



FIRST FLOOR

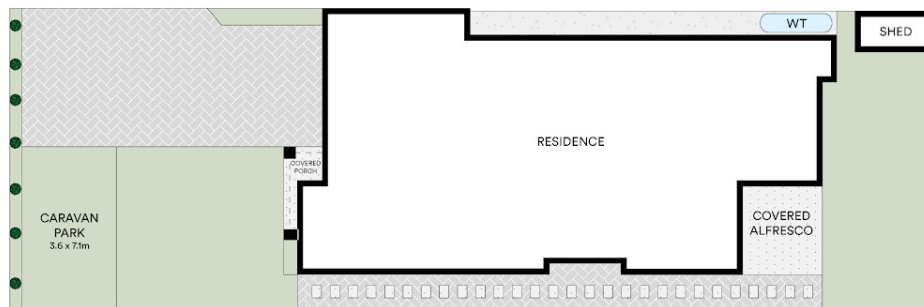

SITE PLAN

ARTIST'S IMPRESSION ONLY: While every attempt has been made to ensure the accuracy of this floor plan's areas and measurements of doors, windows, rooms and all other items are approximate and no responsibility is taken for any error, omission, or mis-statement. This plan is for illustrative purposes only and should only be used as such by any prospective purchaser.



Disclaimer: Please note this floor plan is for marketing purposes and is to be used as a guide only. All dimensions are estimates only and may not be exact measurements.