

# FOR SALE

## UNDER CONTRACT

This absolutely stunning home is architecturally designed to enjoy coastal living at it's best. With a gorgeous Rainforest backdrop that will absolutely captivate you, you will never want to leave home. Elevated on a nice quiet, no through street and just minutes to the sandy shores of Lamberts Beach, this amazing home is low maintenance, cool and exceptionally private. Everything focus's around the large, timber deck that is completely surrounded by nature. As you walk through the front door, step down to the large, open plan living area with extra high, cathedral ceilings and polished timber floorboards throughout. The kitchen is fully equipped with brekky bar, ample cupboard space and views out over the gardens. All bedrooms have built in robes, ceiling fans and the main bedroom has a walk in robe and ensuite and is located to the rear of the home with sliding glass doors out to the deck. There is a double, undercover carport to the front of the home, garden shed, nature reserve on one side and if you like birdlife, you'll really love living at Grace Crescent. Surrounded by quality neighbours and Slade Point is a beautiful little community which has everything you need from Shops, restaurants, daycare, school, medical centre, scenic lookouts, whale watching, bushwalks and more. This lovely home really has a very special feel and is fresh and ready to move into. Estimated Rental Return \$590 to \$630p/w

3 BED | 2 BATH | 2 CAR

### PRICE:

SOLD BY JODIE COWIN

### OPEN FOR INSPECTION:

N/A



**Jodie Cowin**

**0407211322**

jodiecowin@atrealty.com.au

[www.atrealty.com.au](http://www.atrealty.com.au)

SITE PLAN

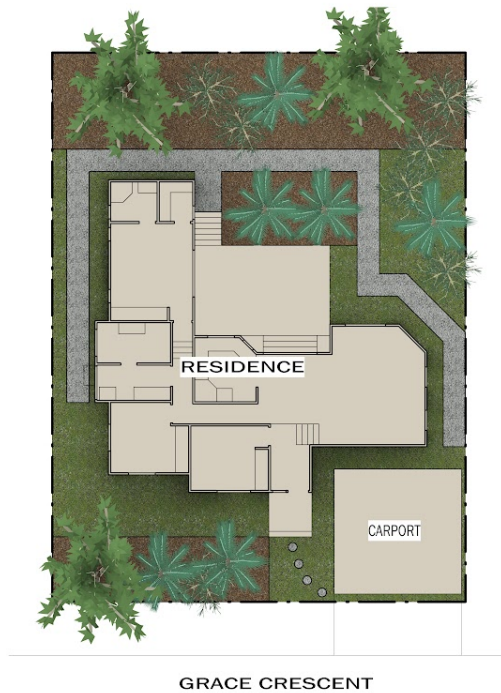

GRACE CRESCENT

FLOOR	AREA (APPROX.)
RESIDENCE	145 m <sup>2</sup>
CARPORT	32 m <sup>2</sup>
TOTAL AREA	177 m <sup>2</sup>

FLOOR PLAN



This plan is only to be used as a visual aid by any prospective purchaser. Therefore all measurements are only approximate and no responsibility will be taken for any errors.

12 GRACE CRESCENT, SLADE POINT

JODIE COWIN @realty

Disclaimer: Please note this floor plan is for marketing purposes and is to be used as a guide only. All dimensions are estimates only and may not be exact measurements.