



FOR SALE

EASY CARE LIVING IN THE CITY

Situated on the 4th floor of the stylish Metropol complex, this 1-bedroom apartment offers an outstanding opportunity for investors seeking a turnkey investment with tenants in place. With its edgy, modern design and premium inner-city location, offering everything a future tenant could need at their doorstep.

Inside the apartment boasts a well-thought-out open-plan layout that maximizes space and natural light. The living and dining area flows seamlessly onto a private balcony, offering a perfect spot to relax or entertain while enjoying city or garden views. The sleek, modern kitchen comes fully equipped with premium stainless steel appliances, complemented by stone benchtops and ample cupboard space.

The spacious bedroom features built-in wardrobes, providing generous storage while maintaining a minimalist aesthetic. With floor to ceiling double glazed windows you can enjoy a abundance of natural light, The designer bathroom showcases modern fixtures, a large shower, and elegant finishes, creating a sense of luxury and style.

Metropol offers residents access to exceptional communal amenities, including a rooftop spa, chef's kitchen, and relaxation areas, making it a highly sought-after address in Canberra. Just steps from Canberra Centre, Glebe Park, and major transport hubs, this property is perfectly positioned for those who want the best of city living.

Ideal for investors or first-home buyers, this apartment offers a lifestyle of convenience and luxury, with secure tenancies already in place for a worry-free experience.

- Modern one bedroom apartment
- Open-plan living space with contemporary finishes
- Hybrid timber flooring though living
- Master with build in robes
- Kitchen with stone benchtops & SMEG appliances
- Floor to ceiling double glazed windows throughout
- Private balcony enclosed from the elements
- Secure basement carpark & storage cage
- European laundry
- Internal living – 49m2 approx
- Balcony 11m2 approx

1 BED | 1 BATH | 1 CAR

PRICE:
\$439,000

OPEN FOR INSPECTION:
N/A



Sarah Cooper
0478847993

sarah@thepropertyagents.com.au
thepropertyagents.com.au

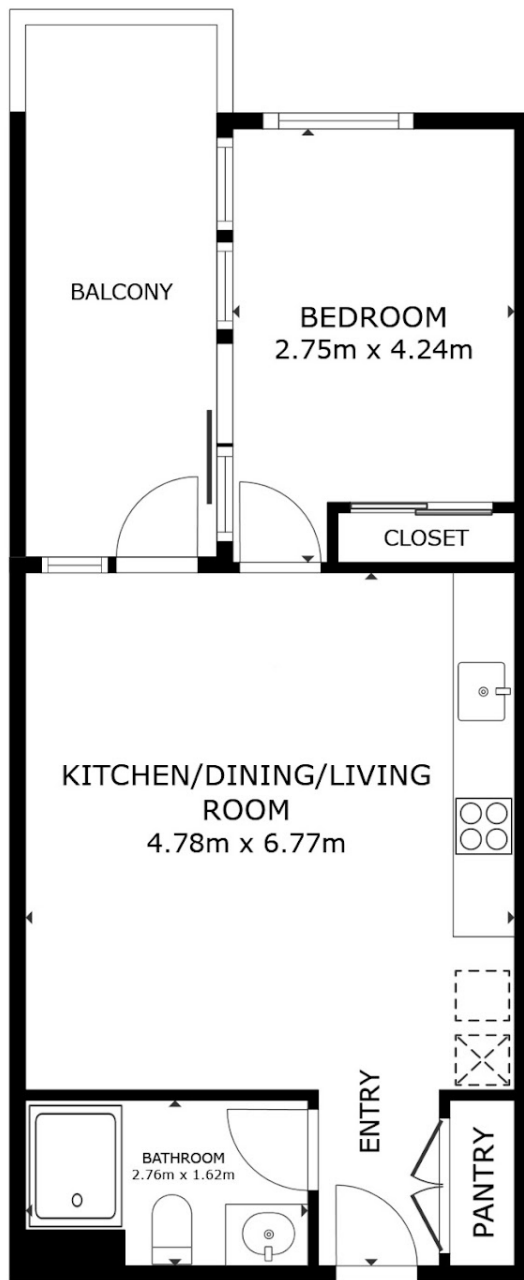

FLOOR PLAN

Disclaimer: Please note this floor plan is for marketing purposes and is to be used as a guide only. All dimensions are estimates only and may not be exact measurements.