

FOR SALE

TO THE MANOR BORN – “MOUNT LOUISA HOUSE”

Walk through the stunning wooden double doors into your dream home. This extravagant manor offers an air of grandeur from the moment you step inside. You are welcomed by an illustrious polished wood stair case, leading up to the large first floor family room with concealed built in kitchenette and bar fridge. This storey hosts 4 immense bedrooms, including the master bedroom with private access to the elegant ensuite featuring a double shower, twin vanity and through access to the walk-in-robe with abundant storage. This bedroom is situated to the front of the home, where you attain stunning views over the whole of Townsville.

Bedrooms 2 and 3 are fitted with built-in-robos, and bedroom 4 boasts its own walk-in-robe. All bedrooms are carpeted and each have sliding door access to the vast 12.5m long balcony which oversees our beautiful city, while capturing natural light and cool breezes. There is a second bathroom on level one, containing a large corner bathtub, with separate powder room and separate toilet. The sewing/craft room is also housed on this floor, offering additional storage and cupboard spaces.

On the ground floor you will find a spacious office with built-in desk and bookcases, adjacent to a third bathroom with toilet and shower. The laundry room has the added benefit of a laundry chute for ease of access from the upper level, and offers ample bench space and cupboards. In the main expanses of the ground floor are the private theatre room, with a set up comparable to a small cinema. This room houses a projector and projector screen for those family movie nights, or entertaining friends with new movie releases.

Step down into your dynamic lounge room with carpet and comfort, beside the huge open plan kitchen and dining space with a kitchen to be envious of. The wooden designs and elegant features include in-lit cupboards, spacious bench tops and a walk-in pantry. This space is perfect for entertaining or for anyone who loves to cook.

At the far end of the house is your own private bar and snooker room, with massive pool table and views through the window of the pristine swimming pool, BBQ and outdoor pizza oven.

Through the dining room you can access the expansive patio and yard which leads out to the enclosed pool and entertaining area.

6 BED | 4 BATH | 7 CAR

PRICE:

Expressions Of Interest

OPEN FOR INSPECTION:

N/A



Ken Entriken

0419689498

kenentriken@atrealty.com.au

www.atrealty.com.au

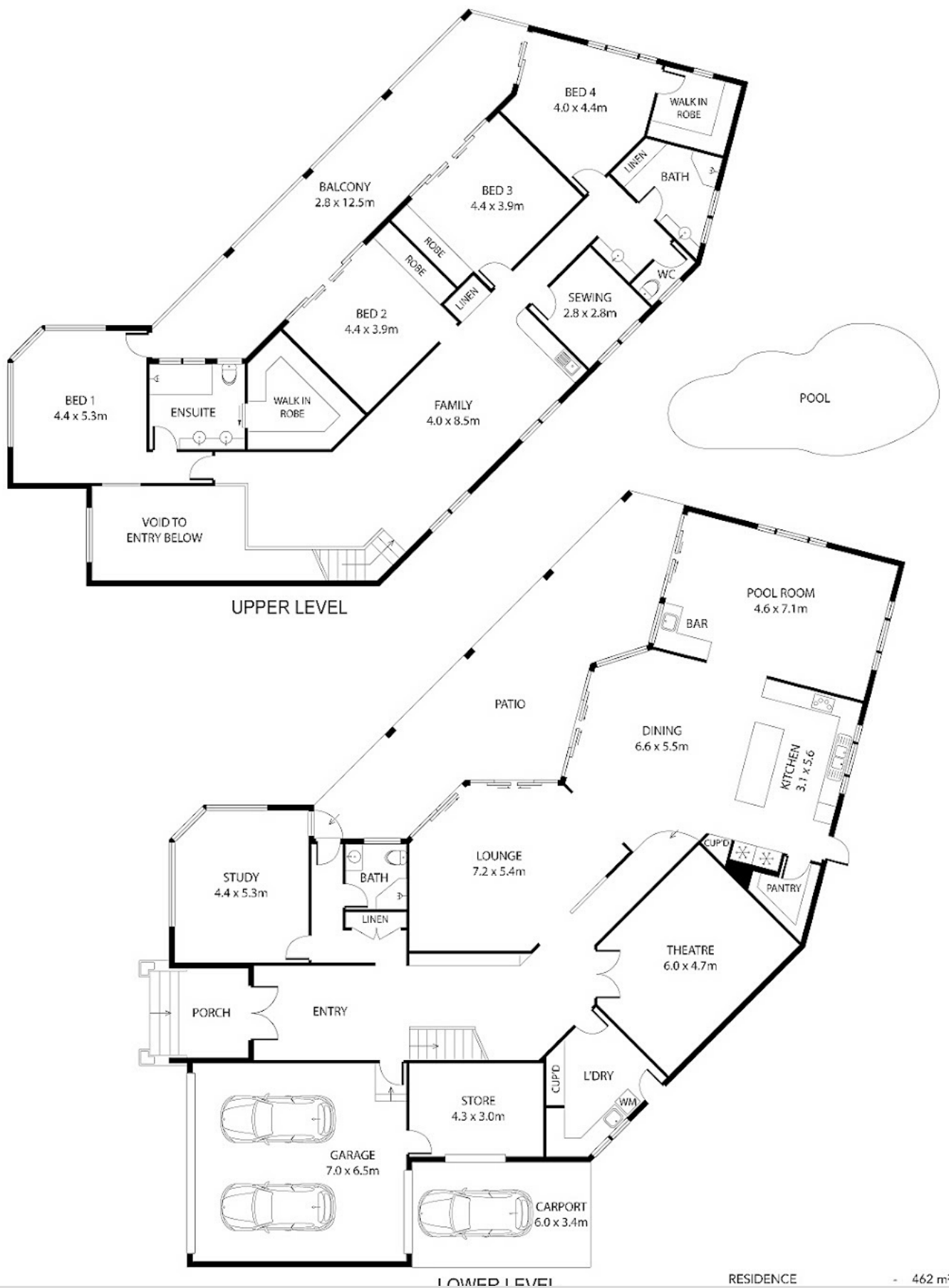

RESIDENCE - 462 m²

Disclaimer: Please note this floor plan is for marketing purposes and is to be used as a guide only. All dimensions are estimates only and may not be exact measurements.

herein is gathered from sources we believe to be reliable. However, we cannot guarantee its accuracy and interested persons should rely on their own enquiries.

BALCONY - 44 m²
TOTAL UNDER ROOF - 632 m²

Ken Enriken
0419689498

kenentriken@atrealty.com.au

www.atrealty.com.au

@realty