



FOR SALE

SUPERSIZE LIVING!

If you are looking for space, look no further!

4 Bedrooms - 2 bathrooms - 3 toilets - 2 living - Separate Dining - Large Office - Double Garage - 295sqm (more or less)

Step inside this spacious family home and enjoy family living with all the space you could need. Architecturally designed house with high ceilings and large windows to allow for an abundance of natural light, creating a warm and inviting ambiance throughout. The master bedroom is on the ground floor with privacy away from the other bedrooms in the home.

The open-plan living and kitchen area is perfect for entertaining, with a separate dining area for those dinner parties. The large woodburner in the living area will keep the whole house warm in the winter.

The property also features a large separate media room, perfect for family movie nights or as a quiet space to relax and unwind. Two of the bedrooms upstairs share access to a balcony.

There is a paved outdoor area and section size of 670 square meters, there is plenty of space for kids and pets to play.

Located in the sought-after suburb of Huntington, Rototuna school zones, easy access to shops, local restaurants and cafes and easy transport links in and out of the city.

Homes like this don't come around often, so don't wait any longer. Contact Gavin now to schedule a private viewing and make this one your new home. The vendor has already moved and no longer wants to own this property.

LM Realty is here to do business with all agents and their buyers, talk to us for more details.

*Note: the floor area and property information was sourced from Property Guru and/or LINZ.

4 BED | 2 BATH | 2 CAR

PRICE:
Price by Negotiation

OPEN FOR INSPECTION:
N/A



Gavin Hocking
0277555148
gavin.hocking@lmrealty.co.nz
www.lmrealty.co.nz

This floorplan is designed for illustrative purpose only,
to assist in the marketing of this property.
All measurements are approximate.
This floorplan can not be reproduced without consent.

Upper Level

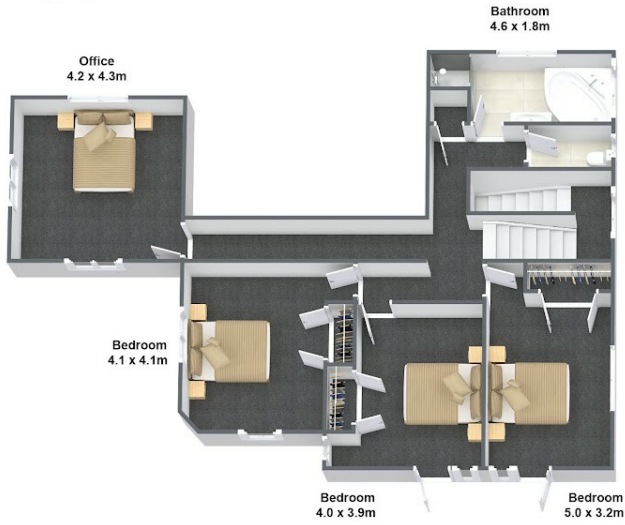

Lower Level

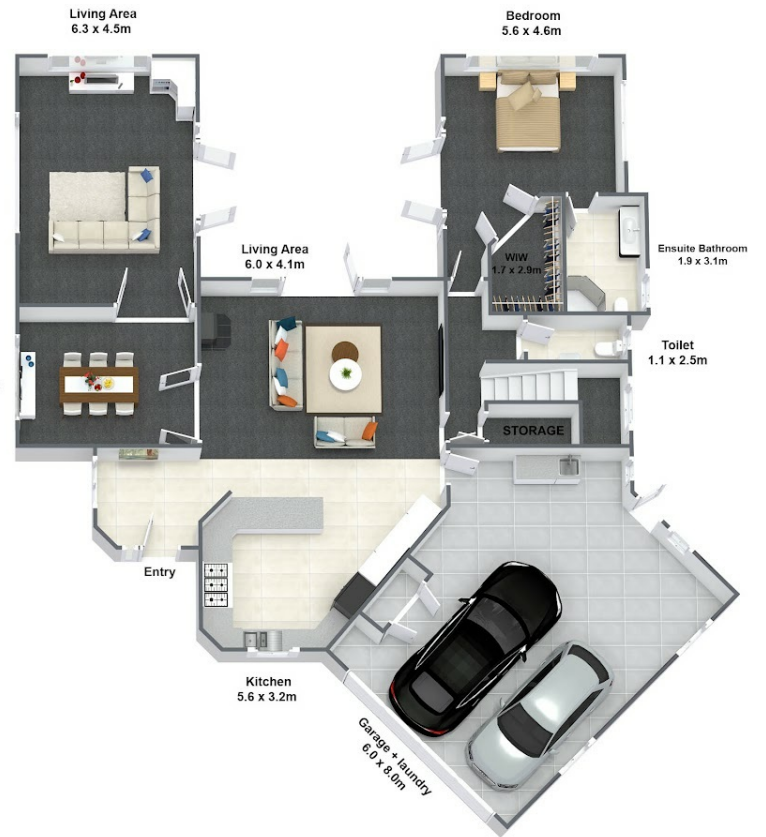

Disclaimer: Please note this floor plan is for marketing purposes and is to be used as a guide only. All dimensions are estimates only and may not be exact measurements.