

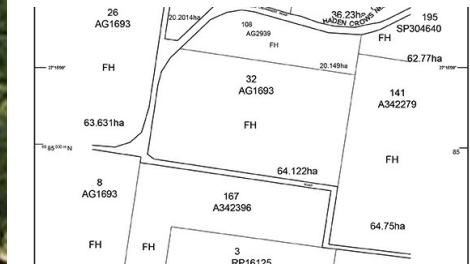

Lorem Ipsum



# SOLD

108 ACRES, HEAVILY TIMBERED, ONLY 12-MINUTE DRIVE FROM CROWS NEST.

Lot 167. Heavily timbered block. Good quality soil. Steep gullies run through this block. Gate access from the Crows Nest Haden Rd. Stockproof fencing is on the eastern, Southern, and Western boundaries. This block has areas of red zone and is covered in young Ironbark trees and lantana.

Crows Nest is one of the most sought-after country towns in the region. It is situated on the New England Highway and is only 35 minutes to Highfields, and a two-hour drive will take you to the Sunshine Coast or Brisbane.

Crows Nest offers many facilities and Amenities: IGA supermarket, Chemist, News agency, doctors, vet, Dentist, school to year 10, Daycare center, Blue care, and an Ambulance Station. and many more facilities.

Disclaimer: We have obtained this property information from sources we believe to be reliable; however, we cannot guarantee its accuracy. Prospective buyers are advised to carry out their own investigations.

0 BED | 0 BATH | 0 CAR

PRICE: \$255,000

OPEN FOR INSPECTION: N/A



**Yvonne Bradley**  
0408181146  
yvonne@atrealty.com.au  
[www.atrealty.com.au](http://www.atrealty.com.au)