



## FOR LEASE

### ECO FRIENDLY - DISABLED COMPLIANT - PERFECT LIFESTYLE LOCATION!

Summerfield is a thriving community of 56 homes set on 8 acres. Located only one hour east of Canberra, 45 minutes from Batemans Bay on the coast and one hour to Goulburn.

Overlooking countryside on three sides and the Braidwood Hospital on the forth, you can enjoy Summerfield and the vibrant heritage township of Braidwood with all it has to offer.

Walk 800 metre to the main street of Braidwood to catch the cafes, markets and an eclectic mix of shops.

#### The Home:

- \* 3 Bedroom, 2 bathroom, 2 car garage
- \* 6.6Kw Solar system with grid feed-in credits
- \* Rainwater tanks for washing machine, toilet and gardens
- \* Vaulted ceiling in living and 9ft ceilings otherwise
- \* Built to be disabled compliant and disabled accessible
- \* North facing sun-room & aspect means warmth and light
- \* Very low maintenance garden
- \* Tandem double drive-through garage

#### Summerfield Facilities include:

- \* Heated Indoor Swimming Pool
- \* Clubhouse and Function Room
- \* Gymnasium
- \* Arts and Craft Centre
- \* Lake, Jetty and BBQ Area

Bus transport is available daily from the main street to Canberra and Batemans Bay which means you definitely won't be isolated here!

3 BED | 2 BATH | 2 CAR

PRICE:

OPEN FOR INSPECTION:

N/A



**Jane Mackenzie-Ross**

**0400472577**

janemross@atrealty.com.au

[www.atrealty.com.au](http://www.atrealty.com.au)



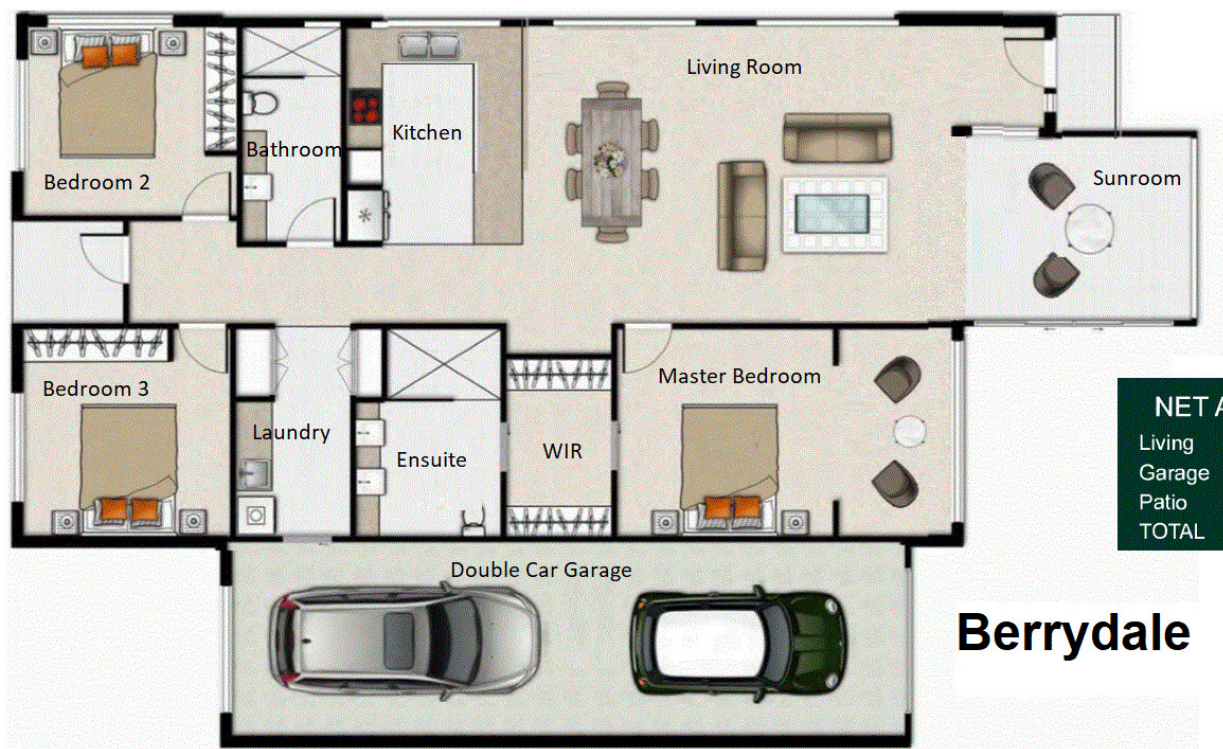

Disclaimer: Please note this floor plan is for marketing purposes and is to be used as a guide only. All dimensions are estimates only and may not be exact measurements.