



FOR SALE

3 BEDDER BRICK HOME IN QUIET CUL DE SAC.

Welcome to your home in the charming suburb of Doonside. This 3-bedroom house is in need of some TLC however it has a very functional floor plan and loads of potential. Nestled on a spacious 560 square meter block, this property offers ample space for you and your family to create your own oasis.

As you step inside, you'll be greeted by a warm and inviting living room, perfect for cozy nights by the fire with your loved ones. There is a second combined dining/ lounge room at the back of the home with natural light pouring in through the large windows adding a touch of brightness to the area. This room overlooks the backyard and the paddocks behind the property.

The kitchen is equipped with all the necessary amenities for the culinary enthusiast in you. There is a breakfast bar and room for a casual eat in area adjacent.

There are three bedrooms with built ins and ceiling fans, and they are serviced by a main bathroom which has a vanity and a spacious shower perfect for unwinding after a long day.

There are tiled floors throughout the living areas.

The true highlight of this property is the outdoor entertainment area being a covered deck area around the side of the home. Whether it's a summer barbecue with friends or a quiet evening with a glass of wine, this space offers the perfect setting for any occasion. The fully fenced yard ensures privacy and security, making it an ideal place for children and pets to play freely.

For those who love to tinker and create, this property also boasts a workshop, perfect for DIY projects and hobbies. The eco-friendly features of solar panels and a water tank not only reduce your carbon footprint but also save you money on utility bills.

But that's not all, with secure parking for two cars you'll never have to worry about finding a parking spot again. And the extra sheds provide ample storage space for all your tools and outdoor equipment.

Located in the heart of Doonside, you'll have everything you need at your fingertips. From local schools and parks to shopping centres and public transport, this suburb has it all. And with easy access to major roads and highways, you'll have the luxury of being just a short drive away from

3 BED | 1 BATH | 3 CAR

PRICE:

Expression of Interest

OPEN FOR INSPECTION:

N/A



Judy Pope
0490045875

judy.pope@atrealty.com.au

www.atrealty.com.au

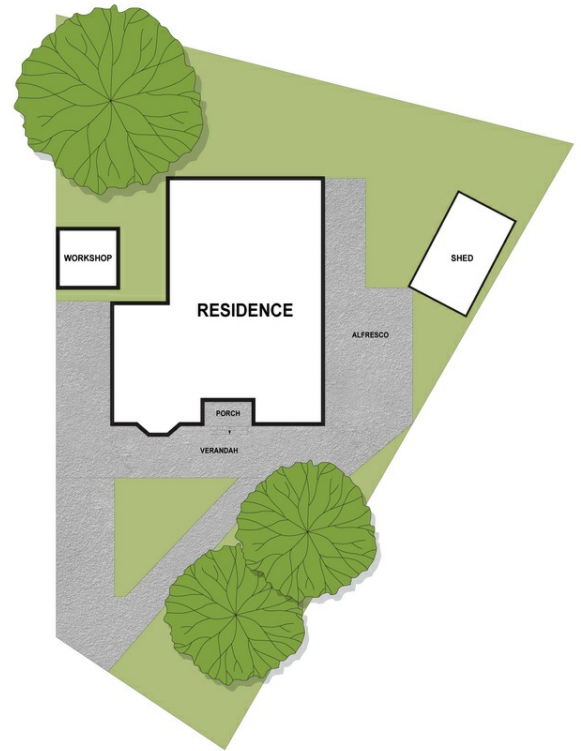

4 SORLIE PLACE, DOONSIDE

DISCLAIMER

PLANS SHOWN ARE FOR MARKETING PURPOSES ONLY. ALL DIMENSIONS ARE APPROXIMATE AND NOT TO SCALE. THEY ARE SUBJECT TO ERRORS AND INACCURACIES AND NO LIABILITY WILL BE ACCEPTED. INTERESTED PARTIES SHOULD MAKE THEIR OWN ENQUIRIES.



Disclaimer: Please note this floor plan is for marketing purposes and is to be used as a guide only. All dimensions are estimates only and may not be exact measurements.