



FOR SALE

MOTIVATED SELLERS - 8+ ACRES, PRIME DEVELOPMENT CORRIDOR - ZONED EMERGING COMMUNITY!

Welcome to : 155-157 LOGANVIEW RD, LOGAN RESERVE

- Zoned Emerging Community for Future Development
- Prime Acreage within a development corridor - no crystal ball required here!
- Land Bank option
- 8+ Acres of glorious land
- No flooding or biodiversity corridor overlays on the property (STCA)
- Incredible location positioned next to QM Future Development site
- Minutes from Rosebank Logan Reserve Subdivision
- Minutes from Local Woolworths Shopping Centre
- Local Primary and High Schools close by
- Tenants in place till March 25 - looking to continue
- Subdividing potential (STCA)

This property also offers a Majestic Classic Queenslander overlooking glorious views of Logan Reserve

Featuring 4 Bedrooms, 1 Bath.

Logan Reserve is earmarked for significant growth, ideal for astute developers and investors. Its central location supports a wealth of possibilities for residential/development or mixed-use projects.

This is an incredible opportunity to secure valuable land, with not many land releases of this size available for development in Logan Reserve.

This property is going to AUCTION 21/12/24 9.45AM, ACCEPTING OFFERS PRIOR TO AUCTION.

Contact Sana for further information.

4 BED | 1 BATH | 2 CAR

PRICE:

OFFERS OVER \$1,700,000

OPEN FOR INSPECTION:

N/A



Sana Campbell

0404299916

sana.campbell@atrealty.com.au

www.atrealty.com.au

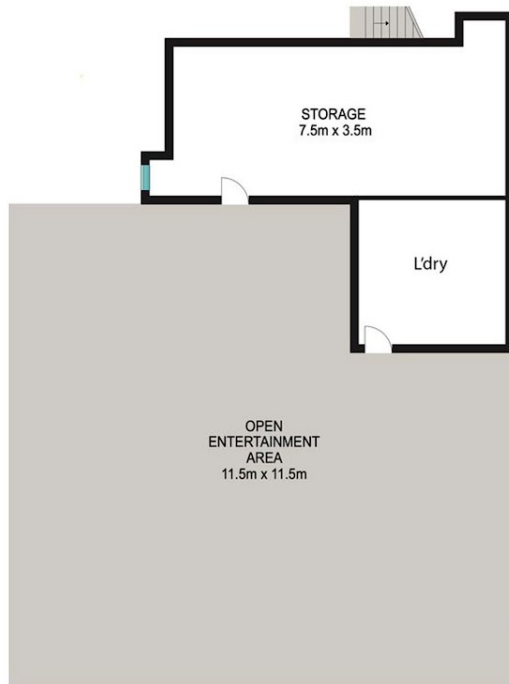

INT: 150 m²
EXT: 175 m²

Scale in metres. Indicative only. Dimensions are approximate. All information contained herein is gathered from sources we believe to be reliable. However we cannot guarantee its accuracy and interested persons should rely on their own enquiries.

157 Loganview Road, Logan Reserve

Disclaimer: Please note this floor plan is for marketing purposes and is to be used as a guide only. All dimensions are estimates only and may not be exact measurements.