



FOR SALE

ESTABLISHED HOME ON 1 ACRE

This exquisite modern federation-style residence in Drouin seamlessly combines luxury, convenience, and comfort. Set on a generous 1 acre, the property boasts established gardens, fruit trees, and an enclosed backyard, ensuring a secure environment for children and pets.

- *4 bedroom
- *2 bathrooms
- *Large 2 car garage
- *Room for a shed
- *Established trees, providing privacy

The heart of the home is the kitchen, designed for those who love to cook and entertain. It comes equipped with a built-in dishwasher, generous counter space, and a dedicated coffee area. The open-plan design effortlessly connects the kitchen, living, and dining areas, creating a harmonious flow throughout the home. This space extends to the outdoor undercover BBQ area, perfect for hosting gatherings or enjoying a quiet evening with friends.

For added flexibility, the fourth bedroom can serve as a rumpus room, home office, playroom, or a cozy reading nook. Comfort is a priority, with both split system air conditioning and heating, as well as ducted heating, ensuring a pleasant atmosphere throughout the year.

4 BED | 2 BATH | 2 CAR

PRICE:
Contact Agent

OPEN FOR INSPECTION:
N/A



Melissa Ahearn
0409183763
mahearn@atrealty.com.au
atrealtypropertysalesgippsland.com.au

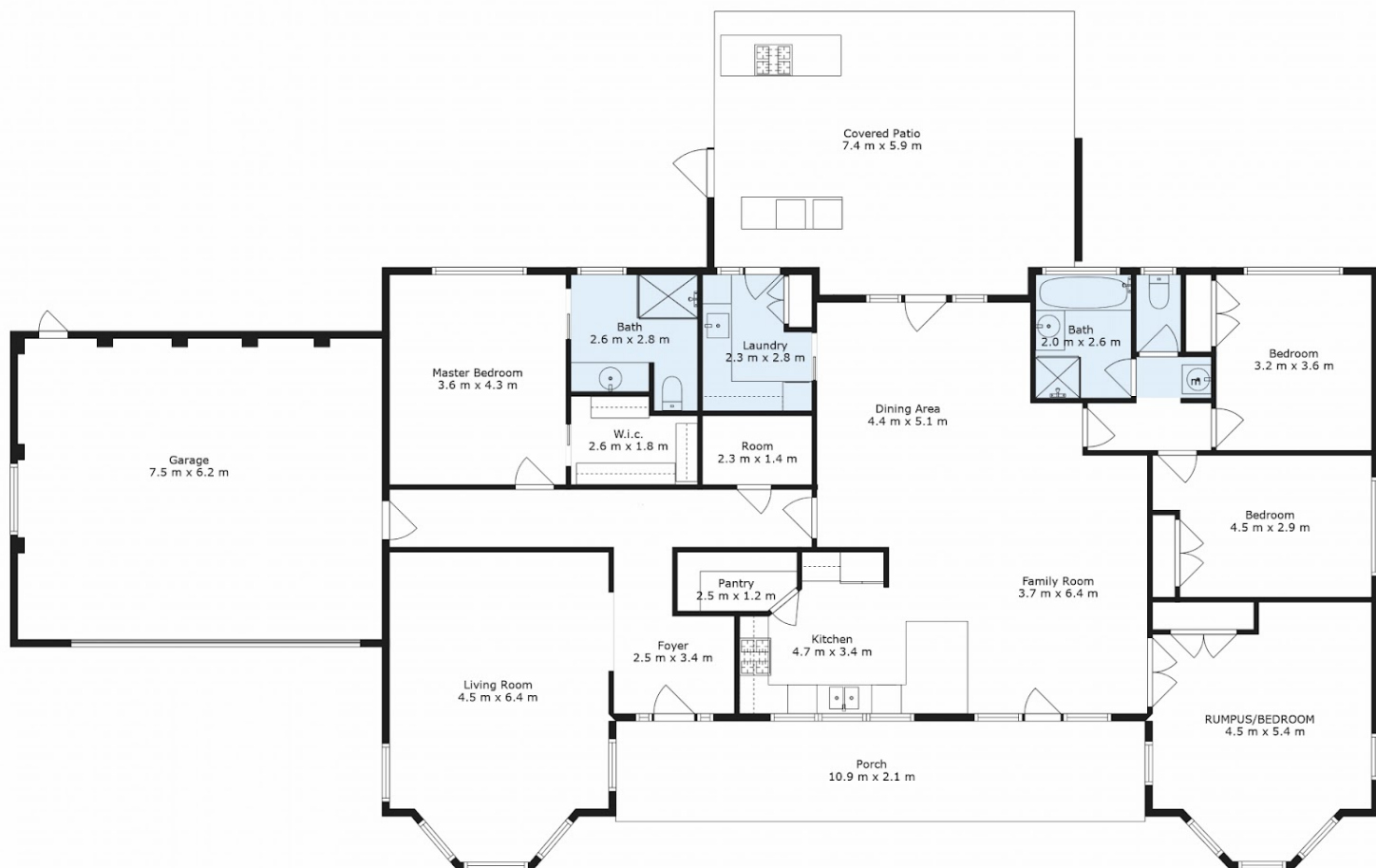

TOTAL: 205 m2
 FLOOR 1: 205 m2
 EXCLUDED AREAS: GARAGE: 47 m2, PORCH: 23 m2, COVERED PATIO: 42 m2

Floor Plan Created By Cubicasa App. Measurements Deemed Highly Reliable But Not Guaranteed.



Disclaimer: Please note this floor plan is for marketing purposes and is to be used as a guide only. All dimensions are estimates only and may not be exact measurements.