



FOR LEASE

WAREHOUSE WITH SHOWROOM/OFFICES - HIGHWAY VISIBILITY

Back on the market for Rent, this sought after location on Hargreaves St, Edmonton.
Total under roof 522m2*.

The warehouse is located in a well established industrial estate with underground power, street kerb and channeling, wide streets and only 9km south of Cairns CBD.

Showroom and offices of approximately 80 sqm each with the balance being open plan warehouse, with internal disabled access toilet.

Two high clearance roller doors of approximately five to six metres, accessible from driveway
Security chain wire fencing, parking on site at front of building
3 phase power is connected and air-conditioned offices

This industrial building has fantastic highway exposure to the Bruce Hwy, Edmonton

Agent Fiona Green At Realty local Cairns agent for more information and inspections

*approximately

0 BED | 0 BATH | 0 CAR

PRICE:

Contact Exclusive Agent Fiona
Green 0428 875 804

OPEN FOR INSPECTION:

N/A



Fiona Green

0428875804

fionagreen@atrealty.com.au

www.atrealty.com.au

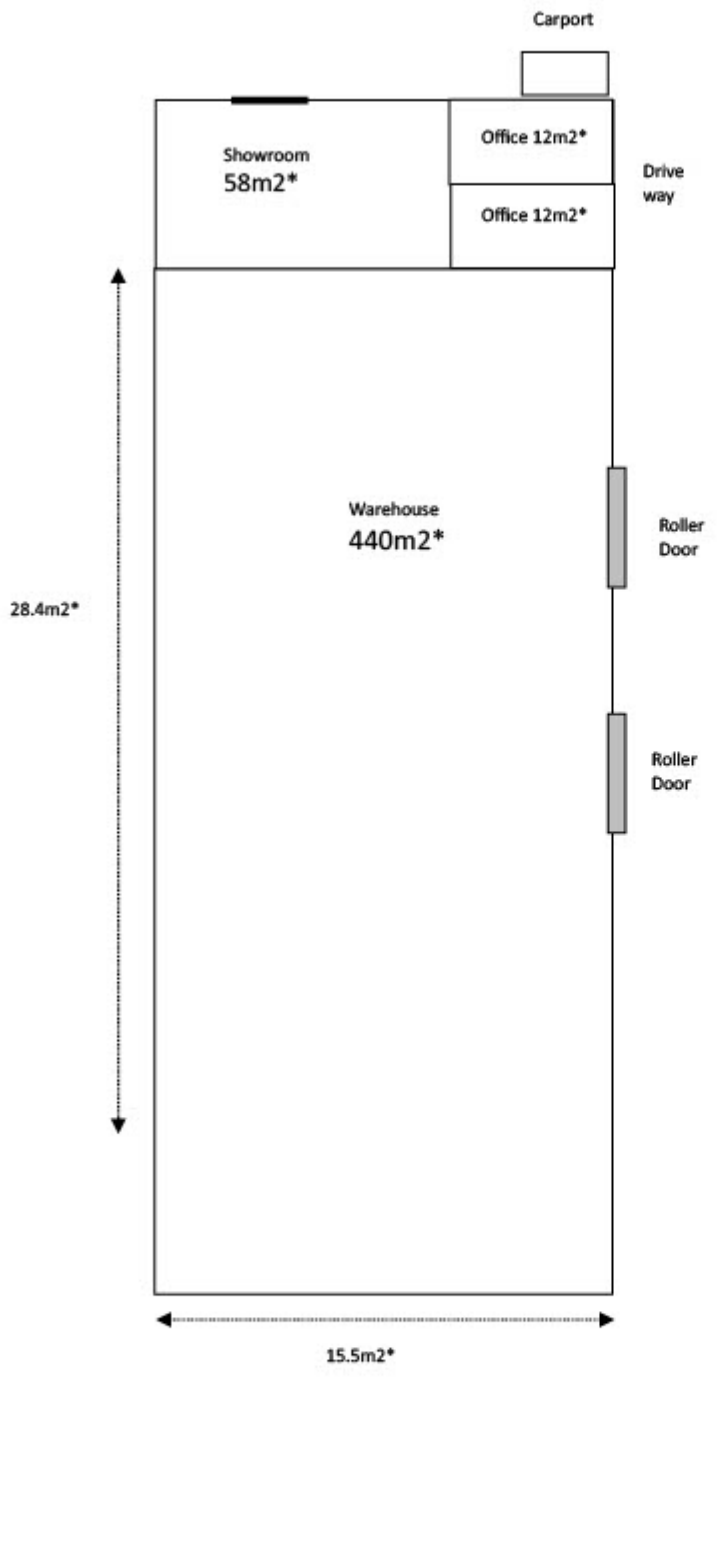

Disclaimer: Please note this floor plan is for marketing purposes and is to be used as a guide only. All dimensions are estimates only and may not be exact measurements.