

FOR LEASE

CONTEMPORARY 2 BEDROOM + STUDY APARTMENT SITUATED ABOVE TOP RYDE CITY

Offering a luxurious and easy lifestyle, this spacious contemporary apartment is securely set in the well-renowned Iluvia building. Located above Top Ryde City, it enjoys the convenience of shops, cafes, restaurants, and buses at its doorstep.

- Two bright bedrooms, both fitted with mirrored built-in wardrobes
- Master bedroom enjoys balcony access and an ensuite with bathtub
- A versatile study separated from the living by timber screens
- Stone kitchen featuring a gas cooktop and a Smeg dishwasher
- Natural light enhances the open-plan living and dining space
- Contemporary bathroom
- Internal European-style laundry
- Ducted air conditioning
- Covered balcony overlooking the common gardens
- Access to resort-style leisure facilities, including pool and gym
- Security building with lift access and video intercom
- Single car space plus storage cage
- Located close to Ryde Public School and public transport

Apartment Size Approx.
Internal including Balcony: 106sqm Level 6
Car Space: 13sqm Level 4
Storage: 3sqm Level 3
Total Area: 121sqm

Built: 2013

Meet the Agent *Entry left of Hurricane's Bar & Grill restaurant
To use the intercom dial 3612 and the agent will guide you up to level 5, where you will exit the lift, and proceed to the first door on the right. Use the intercom again, dial 3612; and proceed to the lift to level 6. the apartment is the 2nd door to your left.

3 BED | 2 BATH | 1 CAR

PRICE:
\$850 per week

OPEN FOR INSPECTION:
N/A



Daniel Sciberras
0433101027
daniel.sciberras@atrealty.com.au
buyingsellingrenting.com.au

Unit 612C, 5 Pope Street, Ryde

3 Bed 2 Bath 1 Car

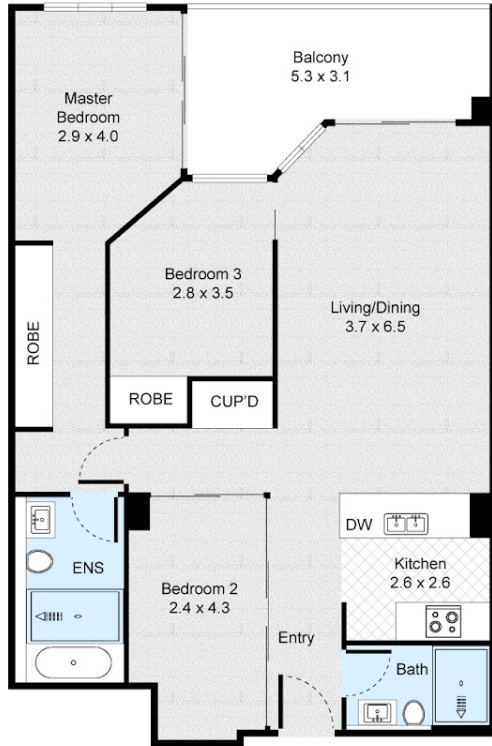

FLOOR PLAN

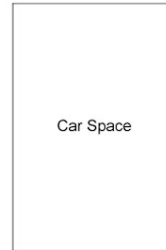

(Not In Position)

CAR SPACE

Internal : 87m²
External : 11m²



All information contained herein is gathered by Little Hinges. Whilst the scanning technology is highly reliable, we cannot guarantee its accuracy and interested parties should rely on their own enquiries.

Disclaimer: Please note this floor plan is for marketing purposes and is to be used as a guide only. All dimensions are estimates only and may not be exact measurements.

Daniel Sciberras
0433101027
daniel.sciberras@atrealty.com.au
buyingsellingrenting.com.au

