



SOLD

MOUNTAINSIDE MANOR

Set in the hills of the prestigious Mount KemplA and boasting the most amazing rural feel, this gorgeous family home has something for everyone. Welcome to 206 Cordeaux Road.

Immerse yourself in country charm with modern amenities and prepare to be captivated by everything on offer, from the warm 3 bedroom home, the expansive back yard with bushy surrounds to the 15m x 6m garage with car hoist perfect for the home business or car enthusiast.

The light-filled interiors provide a sense of space and comfort and boast 3 great sized bedrooms with high ceilings throughout and ornate cornices, bringing the heritage of Mount KemplA to your attention. The main bedroom features a walk through wardrobe into a beautiful ensuite with splashes of federation style whilst bedroom 2 continues the theme and also affords under-floor ducted air conditioning throughout. A lux Tasmanian Oak kitchen is well appointed with stainless appliances plus ample stone benchtops and overlooks the family-friendly dining area. A beautiful lounge room serves as the heart of the home and is topped off with a gorgeous gas fireplace and surrounded by intricate led light windows. Upstairs you are greeted by a 2nd living room and 3rd bedroom with a cleverly designed pitched roof to accentuate views of your leafy surrounds. The 2nd level is perfect as a guest bedroom or teenagers retreat. The choice is yours.

Outside is where this amazing home really comes to life. The back entertaining deck overlooks an expansive backyard featuring designer retaining walls and garden beds custom built by a stone mason to enhance the natural surrounds and gazebo for those summer nights dining to the music of the mountain. A 15m x 6m garage has been built specifically to cater for the home trades man, with enough room for 6 cars and features a built in car hoist, bathroom, loft storage and attic space, making this garage every man's dream but could very easily be converted into a granny flat with ease.

Mount KemplA features some of the Illawarra's most unique real estate and is amongst the most sought after suburbs in NSW, with walking tracks, hobby farms and award winning pubs you will love everything suburb has to offer. Don't miss this rare opportunity to move into an iconic area offering so much yet potential for so much more. Phone Peter Bullman today for more information.

3 BED | 3 BATH | 4 CAR

PRICE:
\$1,631,000

OPEN FOR INSPECTION:
N/A



Peter Bullman
0401394394

peterb@atrealty.com.au
www.atrealty.com.au

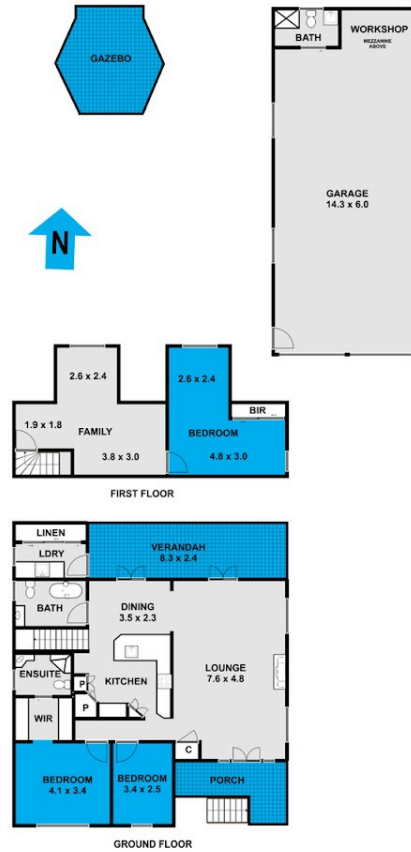

This floor plan including furniture, fixture measurements and dimensions are approximate and for illustrative purposes only.
@Realty gives no guarantee, warranty or representation as to the accuracy and layout.
All enquiries must be directed to the agent, vendor or party representing this floor plan.

206 Cordeaux Road Mount Kembla

Disclaimer: Please note this floor plan is for marketing purposes and is to be used as a guide only. All dimensions are estimates only and may not be exact measurements.