



SOLD

GARDEN COTTAGE FULL OF CHARM & CHARACTER

About this space:

This garden cottage was a dream conceived a few years ago when the owner purchased the 547m² lot. Few could resist the charm of this quaint cottage house combining hardy planks exterior cladding, alluring verandahs, inviting entry and cosy interiors with a touch of quirky. The home is full of pieces collected over the years by the owner to add an eclectic vibe. It's easy to understand the appeal of owning a country cottage on an Island ... well now you can, right here on Macleay Island.

The owner has poured her soul into creating this pretty home surrounded by tropical gardens with a cottage feel to it, mixing lots of shrubs with colourful annuals. There is so much to love about this garden and much thought and care has been utilised in a very inventive way using colour, flower and foliage, form and texture to create an inspirational garden. Timber decks and outdoor log seating add to the atmosphere in this very private space.

Just a few of the many features:

- The residence sits on 547m² lot in a quite sought after neighbourhood just three minutes to water.
- The home is a new build and is still under builder warranty.
- Hidden gardens with tropical inspiration, timber decks and seating.
- Open plan modern kitchen, lots of cupboard and bench space with a leafy outlook.
- The inviting dining nook and lounge spaces are combined with air-conditioning and fans throughout.
- Two well sized bedrooms are both air-conditioned, built-in-robos and are light and airy.
- Well-appointed bathroom with timber look-alike tiles and walk-in shower and a linen cupboard.
- There is an office space off from the hallway the living and bedrooms and a Juliette laundry.
- A covered breezeway and timber deck leads you out to an enchanting backyard.
- The property has lovely timber and corrugated fencing making it ideal for pets, plus a lock up shed and parking space for two cars.
- Emerald Isle is just around the corner and has the best health food store, cafe, hairdresser, pet store and fish & chip takeaway.

Click this link to take a tour of the home <https://my.matterport.com/show/?m=CnjTCpA97wi>

2 BED | 1 BATH | 2 CAR

PRICE:
\$422,500

OPEN FOR INSPECTION:
N/A



Gaylia Griffiths
0419879037
gayliagriffiths@atrealty.com.au
www.atrealty.com.au



FLOOR PLAN

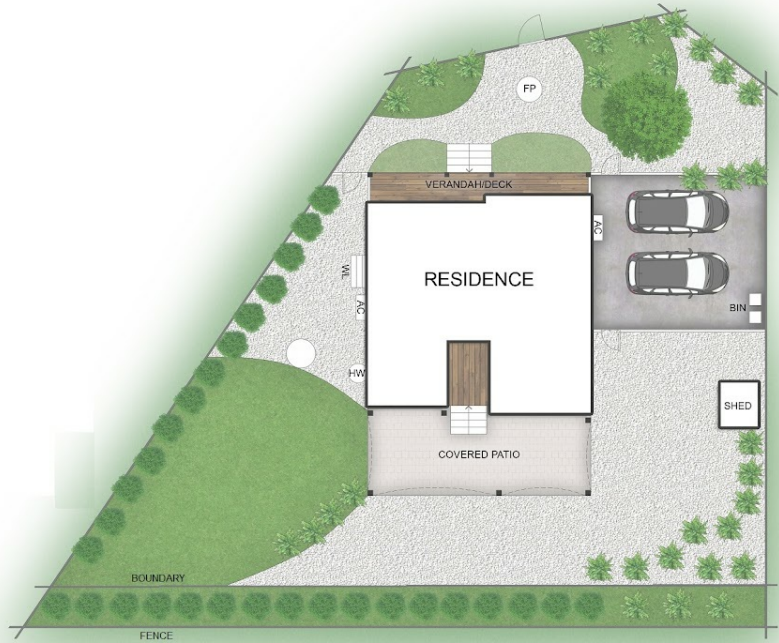

SITE PLAN

This floor plan including furniture, fixture measurements and dimensions are approximate and for illustrative purposes only. BoxBrownie.com gives no guarantee, warranty or representation as to the accuracy and layout. All enquiries must be directed to the agent, vendor or party representing this floor plan.

Approx. Sqm	House	75 Sqm
	Decks	16 Sqm
	Total	91 Sqm



1 Acacia Court Macleay Island Queensland

Disclaimer: Please note this floor plan is for marketing purposes and is to be used as a guide only. All dimensions are estimates only and may not be exact measurements.