



FOR SALE

STYLISH ARCHITECTURAL HOME ON THE COAST

This breathtaking architecturally crafted residence exudes charm and a relaxed coastal vibe. Nestled in a serene and scenic corner of Kilcunda, it's just minutes away from the beach, pub, and local shops. The stunning split-level residence boasts three generously sized bedrooms, each featuring built-in robes.

It offers a chic loft lounge area enhanced by breathtaking picture windows, to take in the treetop atmosphere, while the well-appointed kitchen and dining space showcases floor-to-ceiling timber doors and windows that lead out to an expansive north-facing deck. This outdoor haven includes a hot and cold shower, ideal for rinsing off sandy surf toes.

Additional stand out features comprise a spacious carport featuring a generous storage room/workshop, reverse cycle heating and cooling, a meticulously designed bathroom, an internal laundry, and plenty of tailored storage and shelving options.

We LOVE the harmonious "flow" of this residence, where timber floors effortlessly connect each level, resulting in a highly functional and inviting living space.

For more detailed info visit the dedicated property website at www.4hillstreet.com

The thoughtful architectural elements evoke a remarkable sense of openness and light, embraced by lush, mature trees and gardens. This tranquil home truly needs to be experienced in person to be fully appreciated. A large solar array strategically positioned on the roof takes full advantage of the northern orientation, effectively minimising running costs. Seize this incredible chance to join the exclusive Kilcunda Market and acquire this distinctive home.

3 BED | 1 BATH | 2 CAR

PRICE:
\$749,000 - \$820,000

OPEN FOR INSPECTION:
N/A



Leo Edwards
0472523445
leo@atrealty.com.au
www.atrealty.com.au

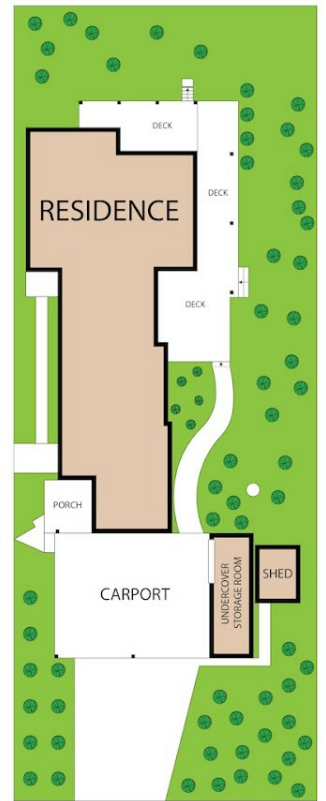
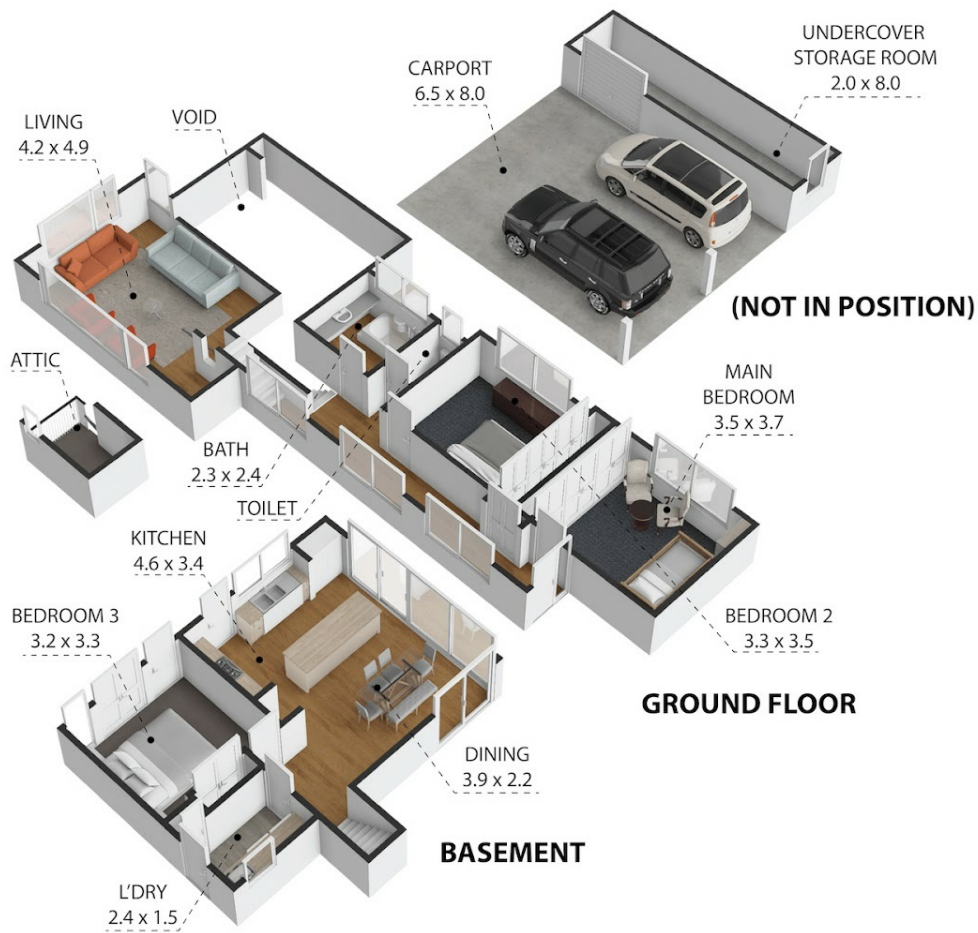

4A Hill Street, Kilcunda, VIC, 3995
TOTAL APPROX. FLOOR AREA 138 SQ.M

Whilst every attempt has been made to ensure the accuracy of the floor plan contained here, measurements of doors, windows, rooms and any other items are approximate and no responsibility is taken for any error, omission, or misstatement. This plan is for illustrative purposes only and should be used as such by any prospective purchaser.

INVERLOCH
WESTON
@realty

Disclaimer: Please note this floor plan is for marketing purposes and is to be used as a guide only. All dimensions are estimates only and may not be exact measurements.