



FOR LEASE

4 BEDROOM FAMILY HOME WITH SHED - ONLY A SHORT WALK TO THE BEACH

Set on a large allotment is this family home that would be suitable for young or growing families, or would make an ideal investment property.

Boasting 4 good size bedrooms, a spacious North facing light filled lounge, separate dining room with adjacent updated kitchen. The bathroom has a bath, shower and there is a separate toilet. The home is also fitted with reverse cycle air-conditioner in the lounge.

Outside, the verandah offers an entertaining area that overlooks the low maintenance rear yard. There is also handy drive through access to the rear Garage providing ample off-street parking.

Conveniently located within a stones throw to local schools, transport, Shops, this opportunity is not to be missed.

Leased by Local SA Agent

TO INSPECT OR APPLY:
PLEASE EMAIL OR PHONE AGENT FOR APPLICATION

We do NOT accept 1Form, Ignite, 2Apply or any other online type of tenancy application form. You must apply using the provided application link sent to you once you enquire.

It is an agency and owner policy that each person over the age of 18yrs old wishing to live at the property is required to apply and provide identification and supporting documents.

To inspect this property, you will be required to provide the agent onsite with your name, best contact number and email address. Failing to provide this information for security and safety reasons may result in being refused entry. RLA 269823

4 BED | 1 BATH | 0 CAR

PRICE:
\$550 per week

OPEN FOR INSPECTION:
N/A



Trevor Lambert
0412396306
trevor@atrealty.com.au
www.atrealty.com.au
RLA: 269823

30 Quinliven Road, Aldinga Beach

Should you find this property interesting
may we recommend you register your
interest by leaving your name and contact
telephone number with the Sales Consultant.
We would be pleased to make every endeavour
to contact you if the property is to be sold.

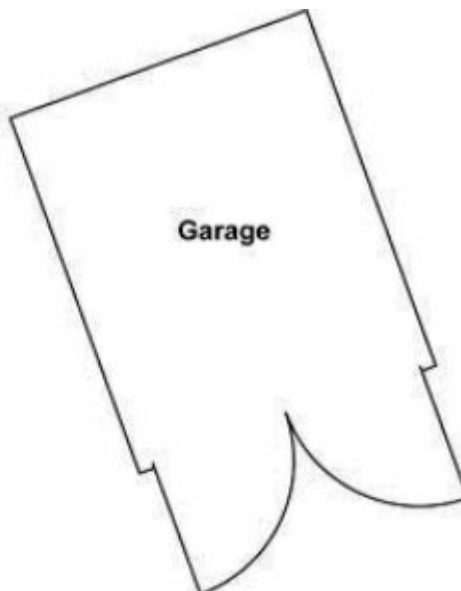

This drawing is for illustration purposes only.
(Drawing is not to scale)

The drawing and the information contained is
not intended to be part of any contract. All
measurements are approximate and details intended
to be relied upon should be independently verified.

ESTIMATE OF AREA

HOUSE 111.18 Square metres/ 11.95 Squares



Disclaimer: Please note this floor plan is for marketing purposes and is to be used as a guide
only. All dimensions are estimates only and may not be exact measurements.