

## FOR SALE

### EMPIRE VILLAGE HEART | SINGLE LEVEL LIMESTONE & IRON HOME | BY RIVERSTONE HOMES

Empire Village Heart  
Single Level Limestone and Iron Home  
By Riverstone Homes

Shore | By Negotiation From Low \$3M's

This single-story residence by Riverstone Homes - one of Perth City's premium building companies - is of extremely high quality construction, built from solid limestone and iron.

It is a rare example of a family sized home built entirely on one level and is sure to have appeal to downsizers and families alike.

Situated on a large 804sqm landholding with sun drenched north facing rear gardens, there is very little this property doesn't offer.

Designed to encapsulate and trap the abundant warm winter sunshine, all main areas within the home face north and allow the natural light to flood in.

The central living area has soaring high ceilings and comprises of kitchen, family dining and lounge with a wall of North facing bifold doors opening out onto an undercover alfresco lounge area.

The elegant formal lounge and dining areas off the front entrance, also embrace the north light.

The master suite has a huge picture window framing a central water feature amongst the formal gardens beyond.

The indoors flow effortlessly to outdoors via a beautiful undercover alfresco living area.

The first thing you notice upon entering the garden is the bronze water feature and the tranquil

4 BED | 2 BATH | 2 CAR

PRICE:

Shore | By Negotiation From Low  
\$3M's

OPEN FOR INSPECTION:

N/A



**Scott Swingler**

**0403344649**

[scott@shore-property.com.au](mailto:scott@shore-property.com.au)

Shore Property

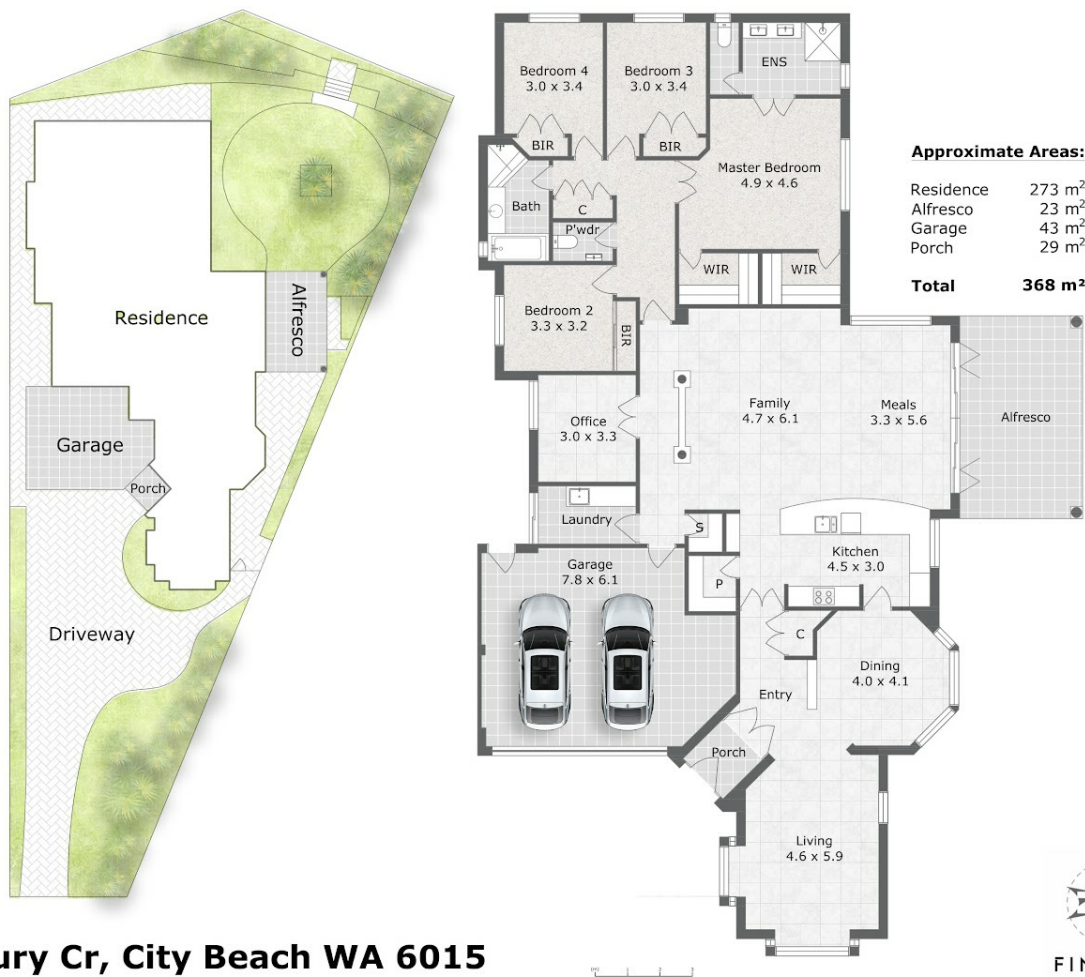

## 30b Norbury Cr, City Beach WA 6015

Care has been taken to ensure the accuracy of this floor/site plan, however all dimensions and areas should be considered as approximate. It has been produced as a guide for the purpose of the property sale or lease only. No credit is taken for the original building or landscape design. This floor plan/site plan design is subject to strict copyright and should not be reproduced, copied or altered without prior consent. The Agent, Vendor & Finesse Photography will not be held liable or responsible for any error, omission, misstatement or use of any data shown on this plan.

Disclaimer: Please note this floor plan is for marketing purposes and is to be used as a guide only. All dimensions are estimates only and may not be exact measurements.