



**SOLD**

## BEAUTIFUL 4-BEDROOM HOME WITH DISPLAY HOME EXTRAS IN PRIME LOCATION.

Beautiful 4-Bedroom Home with Display Home Extras in Prime Location  
4 Wimbledon Drive, Morayfield

Welcome to this stunning 4-bedroom, 2-bathroom home with a double garage, set on a spacious 750m<sup>2</sup> block. Originally built as a display home, it offers a range of quality extras and features that elevate its appeal. With a perfect balance of comfort, style, and practicality, this property provides an ideal setting for a growing family.

### Key Features:

- Master Bedroom: Ensuite, air conditioning, ceiling fan, and walk-in wardrobe
- Spacious Bedrooms: Some with new ceiling fans
- Second Bathroom: Generous space with a separate outdoor toilet
- Modern Kitchen: Seamless flow into living areas, perfect for family meals
- Living Spaces: Formal dining and casual living areas
- Private Outdoor Area: Ideal for BBQs and gatherings
- Generous Backyard: Plenty of space for children and pets
- Fully Fenced: Added privacy and security
- Garden: Beautifully landscaped for maximum curb appeal
- Garden Shed: Extra storage space
- Security Alarm System: For peace of mind
- Additional Highlights:
  - Display Home Extras: Premium finishes and features that set this home apart
  - Prime Location with Exceptional Convenience:
    - 8 minutes to Morayfield Shopping Centre
    - 4 minutes to the Bruce Highway for easy commuting
    - 9 minutes to the nearest railway station
    - 40-minute drive to Bribie Island for 4WD adventures and fishing
    - 30 minutes to Brisbane Airport
    - Close to Morayfield Bunnings and Supa Centre (featuring Woolworths and Aldi)
    - Nearby Caboolture Sports Club for leisure and recreation
    - Excellent access to public transport
    - Range of healthcare options, including medical centres, dental clinics, and aged care facilities

4 BED | 2 BATH | 2 CAR

PRICE:  
\$805,000

OPEN FOR INSPECTION:  
N/A



**Louis Visser**  
**0433801533**  
louis@atrealty.com.au  
[www.atrealty.com.au](http://www.atrealty.com.au)

## 4 Wimbledon Drive Morayfield

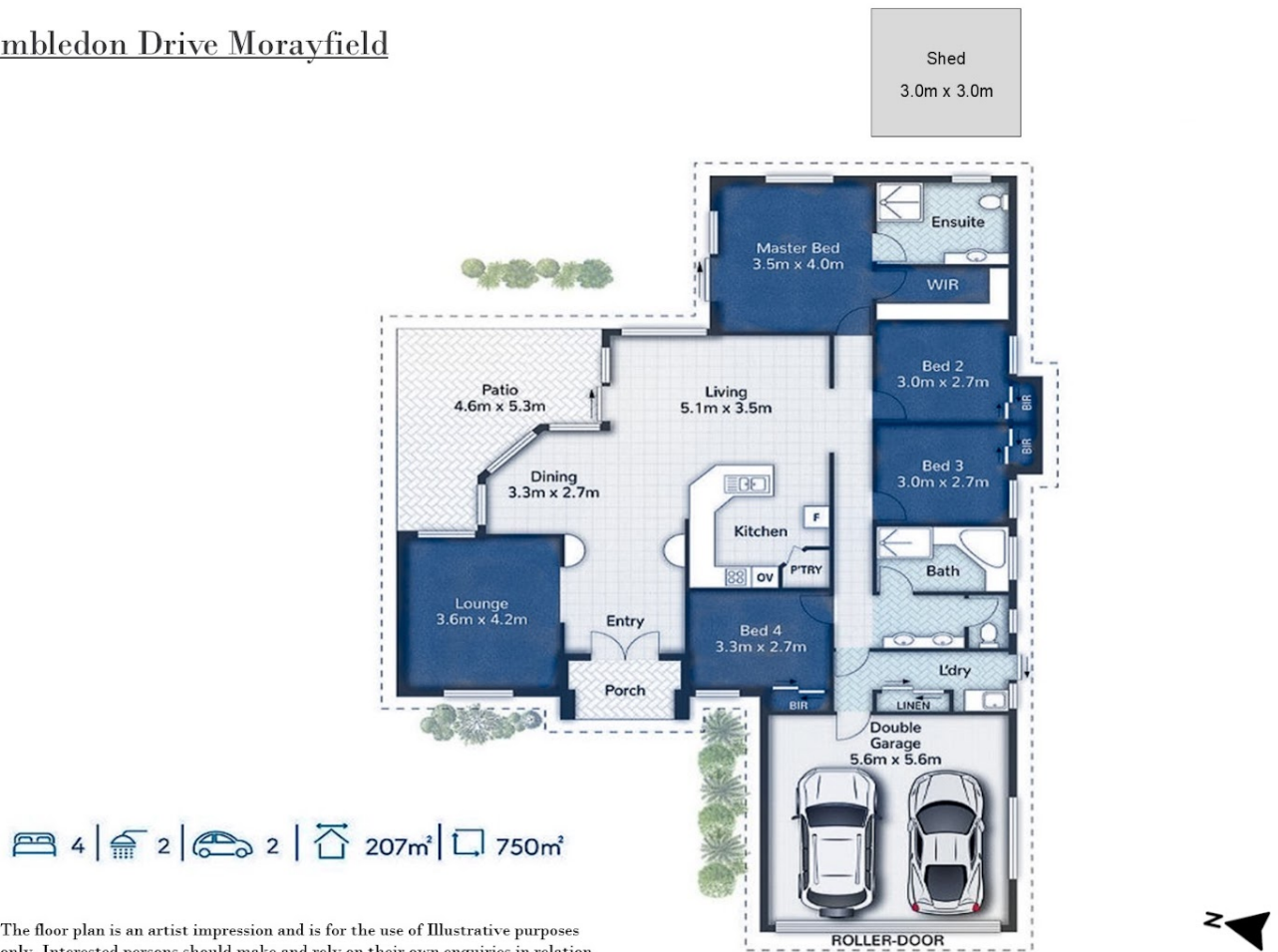

The floor plan is an artist impression and is for the use of Illustrative purposes only. Interested persons should make and rely on their own enquiries in relation to measurements, dimensions, layout, furniture and description.

Disclaimer: Please note this floor plan is for marketing purposes and is to be used as a guide only. All dimensions are estimates only and may not be exact measurements.