



FOR SALE

- LUXURIOUS RESORT STYLE LIVING IN THE HEART OF IT ALL -

Welcome to apartment 21209 at 5 Harbourside Court, Biggera Waters—a premium residence offering the ultimate Gold Coast lifestyle with the perfect blend of luxury, convenience, and vibrant coastal living.

This stunning apartment features:

- 2 spacious bedrooms with built-in robes and abundant natural light
- 2 modern bathrooms with sleek fixtures and premium finishes
- A gourmet kitchen with stone benchtops, stainless steel appliances, and ample storage
- A dedicated study nook, ideal for working from home or study
- Open-plan living flowing to a large private balcony with tranquil water views, perfect for entertaining
- Ducted air-conditioning for year-round comfort and secure car parking
- Storage locker located over car space in garage
- Private balcony views as no neighbours get to peep into apartment due to facing
- Situated in the highly sought-after Harbour Quays precinct, this residence offers resort-style amenities, including a sparkling swimming pool, BBQ area, and beautifully landscaped gardens.

Local Highlights:

- Harbour Town Premium Outlets: A short stroll away for world-class shopping, dining, and entertainment
- Broadwater Parklands: Just minutes away, offering stunning coastal views, walking paths, and recreational activities
- Renowned schools such as A.B. Paterson College, Biggera Waters State School, and childcare centers are within easy reach
- Easy access to the M1 motorway, connecting you to Brisbane or the Gold Coast's vibrant beaches
- Proximity to local cafes, medical facilities, and transport links

This property is perfect for downsizers, professionals, or savvy investors seeking a slice of waterfront paradise.

2 BED | 2 BATH | 1 CAR

PRICE:

JUST LISTED - Open Home
Saturday 8th Feb!

OPEN FOR INSPECTION:

N/A



Jamie Dulics

0499240757

jamie@atrealty.com.au

www.atrealty.com.au

21209/5 Harbourside Court, Biggera Waters

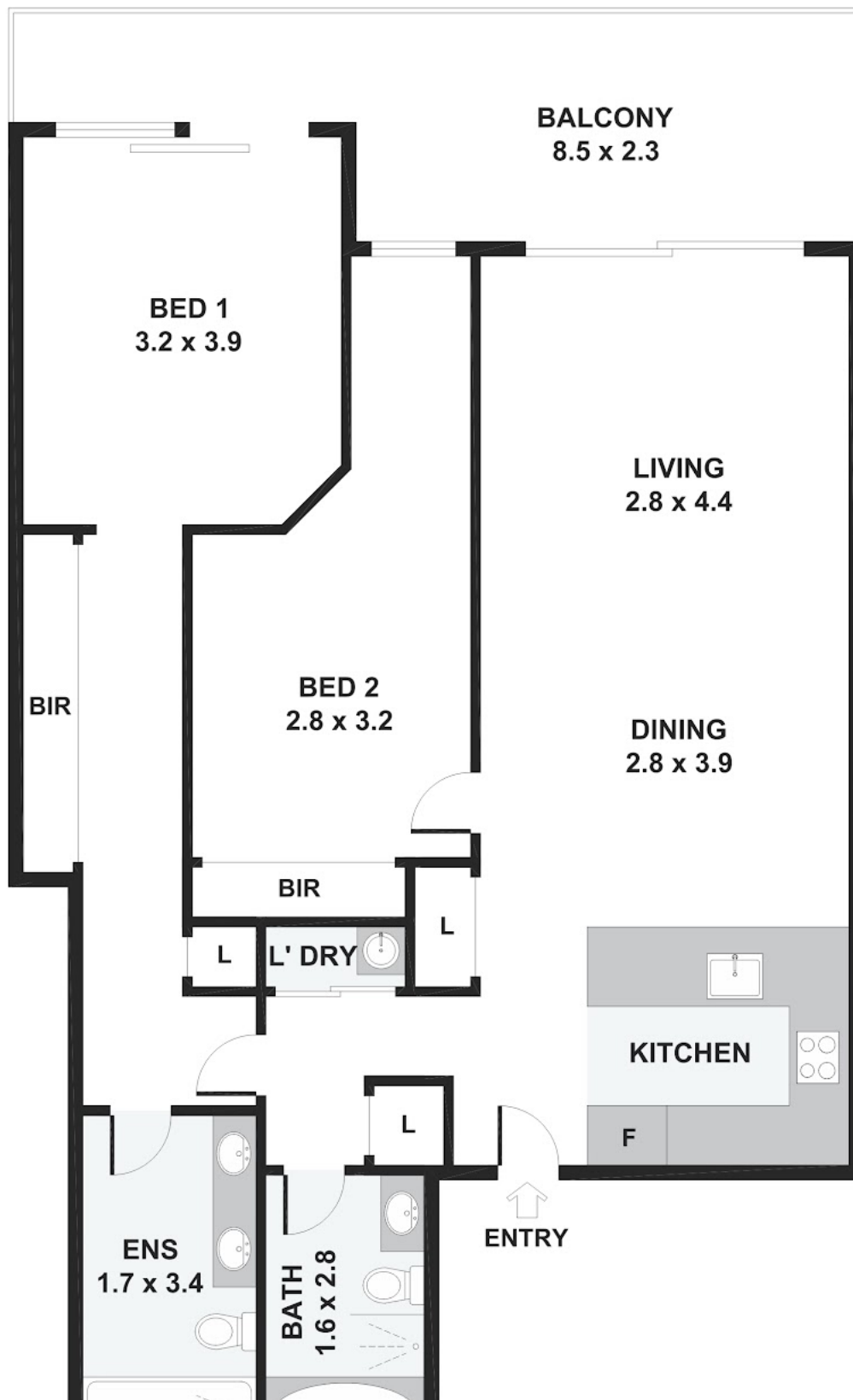

Disclaimer: Please note this floor plan is for marketing purposes and is to be used as a guide only. All dimensions are estimates only and may not be exact measurements.