



**SOLD**

## ARE YOU LOOKING FOR A HOUSE THAT'S READY FOR YOU TO MOVE STRAIGHT IN ? LUXURY, DOUBLE STOREY, MODERN FAMILY HOME IN HOPE ISLAND

A rare opportunity to purchase this fantastic home that enjoys tranquillity and versatility. On the first floor level you'll find the main living and dining room which are surrounded with windows and flooded with natural light, a sensational kitchen and the large entertainers covered deck. To the rear of this floor the Primary bedroom with spacious ensuite and extra generous walk-in robe provides peace, tranquillity and an amazing parent's retreat. The 4th bedroom/study, separate powder room and large walk-in storage/linen cupboard are all on the first floor level, enjoying the cross breezes. You can unwind on the 1st floor in the large, open plan lounge and dining rooms that flow to the sunny kitchen. Equipped with a Smeg 900mm stainless steel range with 6 burner gas cook top & electric oven, stainless steel dishwasher, space for large fridge/freezer, a walk in pantry with ample storage space, stone bench tops and an expansive island bench.

The whole 1st floor benefits from great cross breezes, creating a seamless space for relaxation and entertaining as it leads out to the generous covered entertainment deck that has ample space for outdoor couches, large dining and the BBQ, so it's ideal for entertaining large gatherings of family and friends.

Another, separate family room, 2 further bedrooms, the family bathroom and laundry are all on the ground floor, along with the covered patio overlooking the low maintenance garden and stunning in-ground pool allowing for further entertaining

This bright and spacious four bedroom home is only 10 years old and presents a low maintenance lifestyle that's sure to impress. This home could lend itself to someone looking for casual dual living, families and investors alike.

### HOUSE FEATURES INCLUDE

- Fully ducted air conditioning and ceiling fans throughout
- Energy efficient - Solar hot water and 20 Solar panels of 260W - 5.2kw system
- Fully insulated ceiling and all walls

**4 BED | 3 BATH | 4 CAR**

**PRICE:**  
\$1,400,000

**OPEN FOR INSPECTION:**  
N/A



**Francine Setchell**  
**0408143464**  
francine@atrealty.com.au  
[www.atrealty.com.au](http://www.atrealty.com.au)

# 8 Benetti Crescent, Hope Island

4 Bed 2.5 Bath 2 Car



GROUND FLOOR

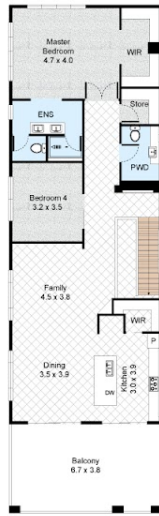

FIRST FLOOR

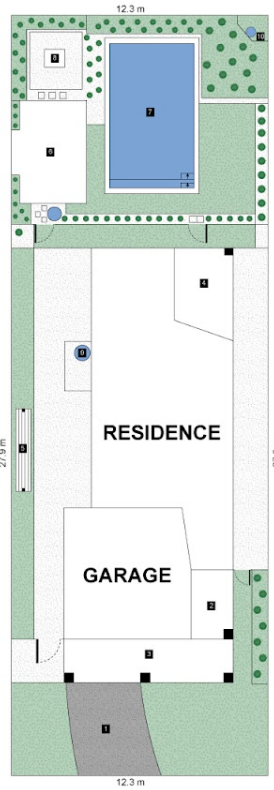

SITE PLAN

## LEGEND

1. Driveway
  2. Porch
  3. Covered Area
  4. Patio
  5. Clothes Line
  6. Deck
  7. Pool
  8. Fire Pit
  9. Hot Water Tank
  10. Pool Pump
- Internal : 236m<sup>2</sup>  
External : 185m<sup>2</sup>



All information contained herein is gathered by Little Hinges. Whilst the scanning technology is highly reliable, we cannot guarantee its accuracy and interested parties should rely on their own enquiries.

Disclaimer: Please note this floor plan is for marketing purposes and is to be used as a guide only. All dimensions are estimates only and may not be exact measurements.

Francine Setchell  
0408143464  
francine@atrealty.com.au  
www.atrealty.com.au

