



Homes4U

SOLD**PRIVATE RESORT-STYLED HOME @ HABITAT.**

Email to schedule a private inspection.

The Habitat in Bridgeman Downs is a tightly held estate surrounded by natural bushland, bike trails and walking paths. The location is super-convenient, approximately 15km to Brisbane City, minutes from local shops, schools and transport and 10min to Westfield Chermside. Brisbane Airport is only 20min away via the Airport Link Tunnel.

23 Fiddlewood Place commands an elevated position on over 1,000sqm of land, overlooking the estate at the end of a quiet cul-de-sac. Private and secure, surprisingly low maintenance with established landscaped gardens and paved entertaining areas overlooking the resort-styled saltwater pool.

The home itself is built to a grand scale in every way with a focus on entertaining;

- Approximately 800sqm of under roof living space
- multiple living and dining areas both inside and out
- 5+ large bedrooms with over-sized wardrobe space
- 5 bathrooms (3 ensuites, 2 bathrooms and a total of 6 toilets)
- The master bedroom is a true 'Parents Retreat' with an enclosed balcony, dressing room and ensuite with double shower
- Large study with built-in storage
- Huge games room, wired for sound and vision, with a built-in wet bar, overlooks the alfresco entertaining and resort-styled pool areas
- Self-contained accommodation above the garage could also be the ideal premises for a home-based business

A builders own family home constructed almost 20 years ago, it is now time for the new owners to add their own style to this fantastic blank canvas. Move straight in and enjoy or make your own tasteful changes - but do it quickly, as this property is sure to be sought-after. Contact Mike by phone on 0402 221 163 or email today.

6 BED | 5 BATH | 4 CAR

PRICE:
\$1,900,000

OPEN FOR INSPECTION:
N/A



Mike Smithers
0402221163
mikesmithers@atrealty.com.au
www.atrealty.com.au



Ground Floor



First Floor

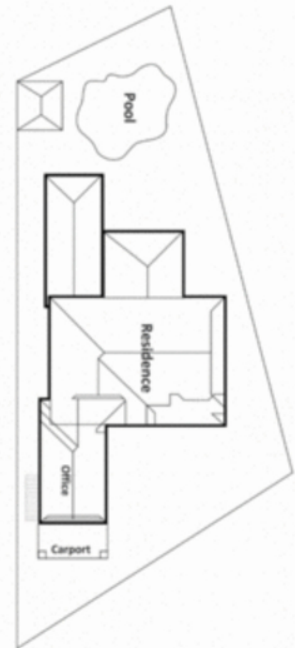

Homes4U
PTY LTD

23 FIDDLEWOOD PLACE, BRIDGEMAN DOWNS

THE FLOOR PLAN INCLUDING FURNITURE, FIXTURE MEASUREMENTS AND DIMENSIONS ARE APPROXIMATE AND FOR ILLUSTRATIVE PURPOSES ONLY. SIMMS AGENCY GIVE NO GUARANTEE, WARRANTY OR REPRESENTATION AS TO THE ACCURACY AND LAYOUT ALL ENQUIRIES MUST BE MADE DIRECTLY TO THE AGENT, VENDOR OR PART REPRESENTING THE PROPERTY

Disclaimer: Please note this floor plan is for marketing purposes and is to be used as a guide only. All dimensions are estimates only and may not be exact measurements.