



**SOLD**

## HUGE PRICE REDUCTION!

Positioned in a quiet cul-de-sac, this well maintained family home offers a low maintenance lifestyle in a super-convenient position.

### Location Benefits:

- Walking distance to Mueller, Grace and Southern Cross Catholic Colleges
- 100m to parkland
- Rothwell railway Station, Bunnings and the Zone Shopping Complex nearby
- North Lakes and the Bruce Highway north and south a short drive
- The Peninsula's sandy beaches and boating facilities only minutes away
- Flood-free area

### Property Features:

- Multiple living areas, air-conditioned for year round comfort
- Sparkling in-ground mineral plunge pool
- Large insulated private outdoor entertaining area
- Thoughtful kitchen layout with ample storage and bench space
- Spacious bedrooms with built-ins, fans and laminated flooring
- Master suite with ensuite and walk-in robe and air-conditioning

Don't wait for the Open Home inspection - Must Be Sold - contact Mike for further information and schedule an inspection today.

**4 BED | 2 BATH | 2 CAR**

**PRICE:**  
**\$731,000**

**OPEN FOR INSPECTION:**  
**N/A**



**Mike Smithers**  
**0402221163**  
mikesmithers@atrealty.com.au  
[www.atrealty.com.au](http://www.atrealty.com.au)

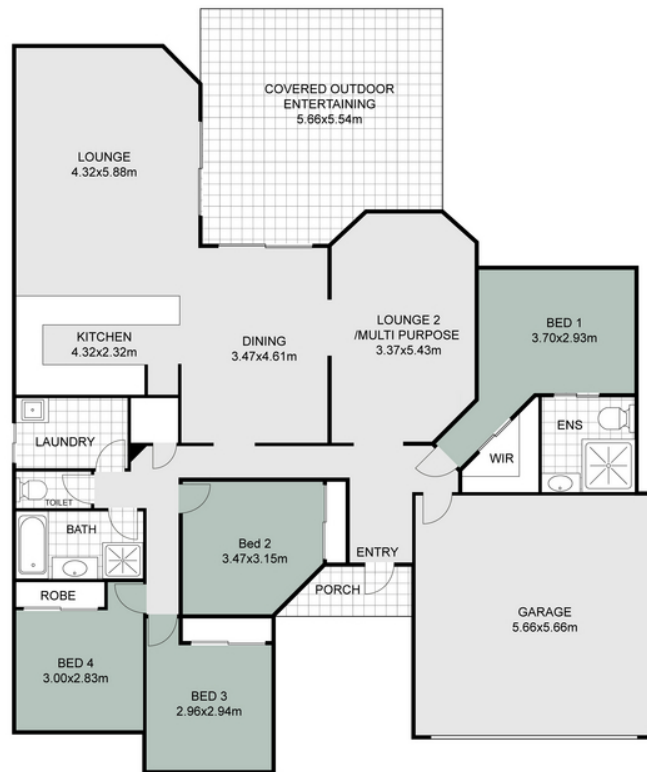

## 10 Bernays Court, Rothwell

THIS FLOOR PLAN INCLUDING FURNITURE, FIXTURE MEASUREMENTS AND DIMENSIONS ARE APPROXIMATE AND FOR ILLUSTRATIVE PURPOSES ONLY. SIMMS AGENCY GIVE NO GAURANTEE, WARRANTY OR REPRESENTATION AS TO THE ACCURARY AND LAYOUT. PLEASE DIRECT ALL QUESTIONS REGARDING THE PROPERTY TO THE AGENT, VENDOR OR PARTY REPRESENTING THE PROPERTY

Disclaimer: Please note this floor plan is for marketing purposes and is to be used as a guide only. All dimensions are estimates only and may not be exact measurements.