

FOR SALE

SOLD! SUPERB VILLA IN EXCLUSIVE ESTATE!

SOLD!

Ladies and gentlemen, we're excited to present to you this outstanding lifestyle and investment opportunity!

Set in a gated community of quality residences in a prime bayside position is this modern free-standing villa.

Offering a host of great features, the home is beautifully presented throughout and has great appeal.

- 3 Built-in bedrooms, main with walk-in robe
- 2 bathrooms, including an ensuite to main
- Beautifully appointed kitchen + island bench
- New high-quality fixtures, fittings and appliances
- Boasting impressive 2,550mm-high ceilings
- Open plan living and dining looking onto a private & tiled alfresco area
- Double garage featuring built-in shelving
- Fully fenced yard with quality Astro-turf for a zero-maintenance lifestyle
- Extraordinary communal area, enjoy the resort pool right next door, BBQ facilities with alfresco kitchen & gymnasium
- In a secured gated community, this home offers peace of mind, privacy and security
- Conveniently located in a friendly local neighborhood, just minutes from shops, schools and essential amenities

And all of this is conveniently close to all local amenities including local parks and walking trails.

Top-tier schools are nearby, including Faith Lutheran College, Carmel College and Bayview.

Brisbane CBD is only 35 min, Gold Coast 45 min and Bayside beaches / fishing just 10 mins.

Folks, don't miss out on this modern villa that offers the perfect combination of luxury, style and comfort.

3 BED | 2 BATH | 2 CAR

PRICE:
SOLD!

OPEN FOR INSPECTION:
N/A



Ben Tafolo
0419260719
tafolo@atrealty.com.au
teamtafolo.com.au

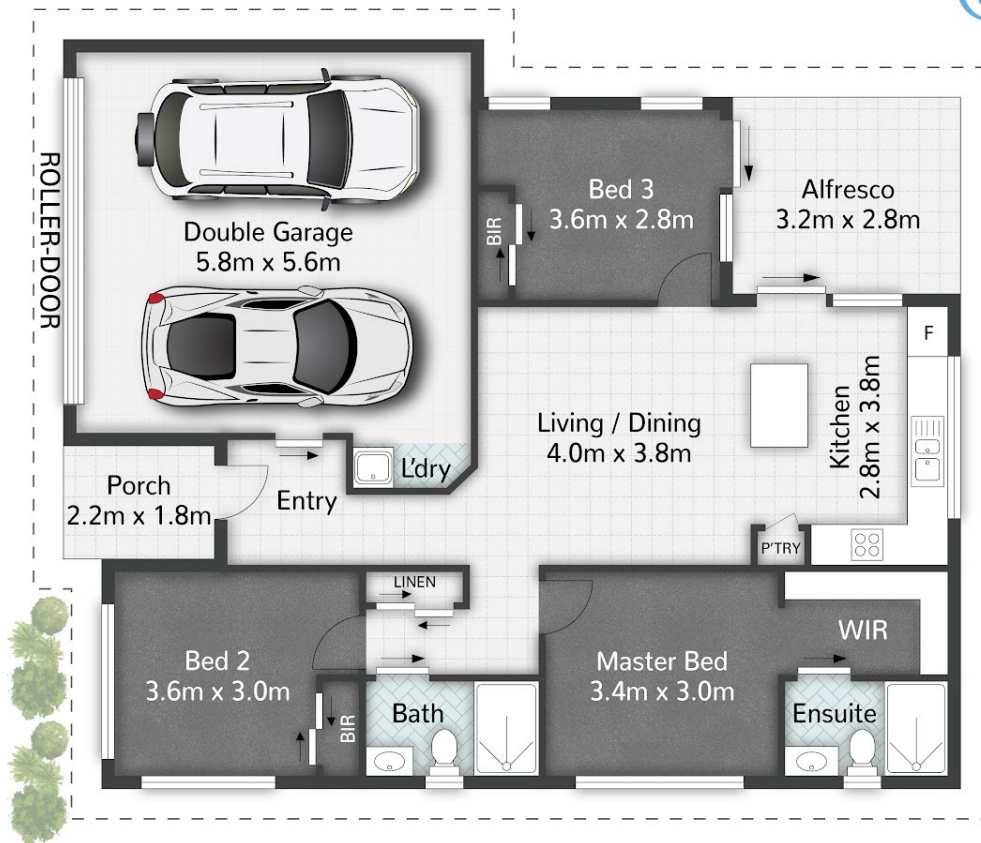

8/30-46 Edina Street **THORNLANDS**

3 | 2 | 2 | 135m² | 182m²

All dimensions are approximate; they are subject to errors and inaccuracies and no liability will be accepted. Plans are shown for marketing purposes only.

Disclaimer: Please note this floor plan is for marketing purposes and is to be used as a guide only. All dimensions are estimates only and may not be exact measurements.