

**SOLD**

## SOLD! QUALITY TOWNHOUSE IN CONVENIENT LOCATION!

SOLD!

Ladies and gentlemen, here is a superb lifestyle or investment and/or opportunity in a great location at an affordable price!

Situated in an elevated location at the top of the complex, this 3 bedroom, 2 bathroom, townhome is conveniently positioned with easy access in and out, and easy reach of the pool and communal facilities.

Currently providing a rental return of \$600 per week with a lease that runs to 25/03/2025, the home would suit either buyers looking for a home to live in, or investors.

There are generous living and dining areas and an upgraded kitchen, much larger than the usual format and including 50mm thick granite bench tops.

There is also a powder room on the lower level, in addition to the main bathroom and ensuite upstairs, and a private courtyard out the back.

In terms of the estate, Greentrees Village is well maintained and presented, and there is on-site management.

The roads are wide and easily navigable, with ample guest parking and the gardens present well.

And there is a resort-style swimming pool and communal electric barbecue and entertainment area.

You can also enjoy peace-of-mind, as the complex has security cameras, and the residents are friendly as well.

And all of this is conveniently close to all local amenities including local parks and walking trails.

**3 BED | 2 BATH | 1 CAR**

**PRICE:**  
\$650,000

**OPEN FOR INSPECTION:**  
N/A



**Ben Tafolo**  
**0419260719**  
tafolo@atrealty.com.au  
[tafolorealty.com.au](http://tafolorealty.com.au)

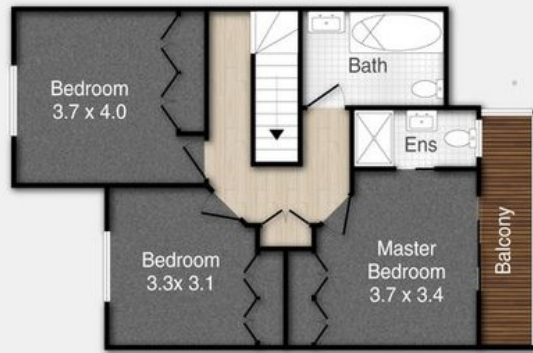

FIRST FLOOR



GROUND FLOOR

PLEASE NOTE THIS PLAN IS FOR MARKETING PURPOSES AND IS TO BE USED AS A GUIDE ONLY. ALL MARKINGS, MEASUREMENTS, AREAS, AND LAYOUT ARE INDICATIVE ONLY AND INTERESTED PARTIES SHOULD MAKE THEIR OWN ENQUIRIES BEFORE MAKING ANY DECISIONS. FLOOR COVERINGS INDICATED ARE FOR ILLUSTRATIVE PURPOSES ONLY AND MAY NOT ACCURATELY PORTRAY ACTUAL FLOOR COVERINGS OF THE PROPERTY. NO GUARANTEES ARE MADE REGARDING THE INFORMATION CONTAINED IN THIS PLAN AND NO LIABILITY FOR ANY INACCURACIES IS ACCEPTED.

Disclaimer: Please note this floor plan is for marketing purposes and is to be used as a guide only. All dimensions are estimates only and may not be exact measurements.