



# SOLD

## COTTAGE CHARM ON MACLEAY ISLAND

### About this property:

This property is situated on a large 718 m<sup>2</sup> block offering ample space for outdoor activities and gardening. There are established lemon, orange, mandarin, bananas and avocado trees. There is a chicken coop that needs a little attention and three chickens that could stay. So many opportunities to enhance the grounds by planting your own vegetable garden or creating a picturesque landscape filled with colourful flowers. The neighbouring property is built on the corner covering approximately 9-lots amalgamated so this home enjoys additional open space views. The undercover Verandah expands the entire length of the front of the home with additional outdoor lounge and the best breezes. The pizza oven stays so you can start enjoying home-made pizzas on the Verandah from day one.

### Just a few of the many features:

- The residence sits on 718m<sup>2</sup> lot in a perfect location with many outdoor features and established gardens.
- Undercover front Verandah expands the length of the home. One side has a huge verandah with a built-in-pizza oven
- Open plan modern kitchen, lots of cupboard and bench space with a leafy outlook.
- The inviting dining nook and lounge spaces are combined with air-conditioning and fans throughout.
- Three well sized bedrooms master with split air-conditioner and one with a wall unit.
- All have built-in robes and windows
- A good-sized bathroom and a separate toilet.
- An old chook pen is there but could do with a little love and the three chickens come with the home.
- The property is fully fenced making it ideal for pets and children.
- Parking space for two cars one under cover and the other in carport.
- Three lock-up sheds, two with power.
- This home is well priced and would benefit with a fresh coat of paint and an update to the bathroom and kitchen areas.

### Arriving by Ferry:

- Happy to pick up and return you to Macleay Island Ferry Terminal upon request.
- We will take you for a quick tour if it's the first time you have been to Macleay Island.

3 BED | 1 BATH | 1 CAR

PRICE:  
\$420,000

OPEN FOR INSPECTION:  
N/A



**Gaylia Griffiths**  
 0419879037  
 gayliagriffiths@atrealty.com.au  
[www.atrealty.com.au](http://www.atrealty.com.au)

Gaylia Griffiths  
0419 879 037  
GayliaGriffiths@atrealty.com.au



FLOOR PLAN

INTERNAL AREA : 101sqm  
EXTERNAL AREA : 67sqm  
TOTAL AREA : 168sqm (APPROX.)

This floor plan including furniture, fixture measurements and dimensions are approximate and for illustrative purposes only. BoxBrownie.com gives no guarantee, warranty or representation as to the accuracy and layout. All enquiries must be directed to the agent, vendor or party representing this floor plan.

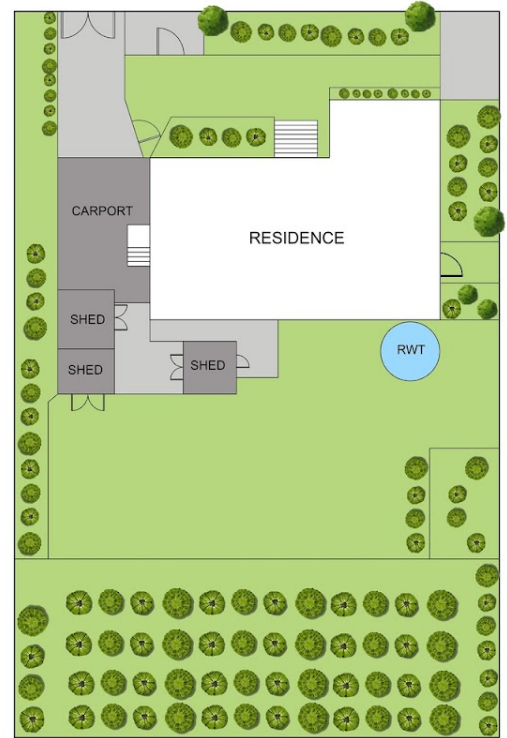

SITE PLAN

8 Jan Street Russell Island Queensland



Disclaimer: Please note this floor plan is for marketing purposes and is to be used as a guide only. All dimensions are estimates only and may not be exact measurements.

Gaylia Griffiths  
0419879037  
gayliagriffiths@atrealty.com.au  
[www.atrealty.com.au](http://www.atrealty.com.au)

