

2 TANBY COURT MUDGEERABA

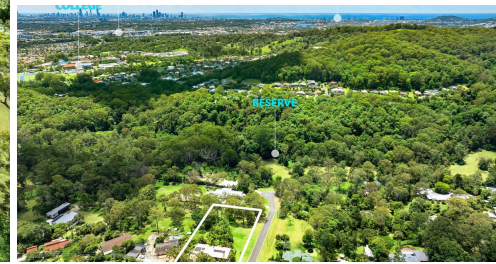
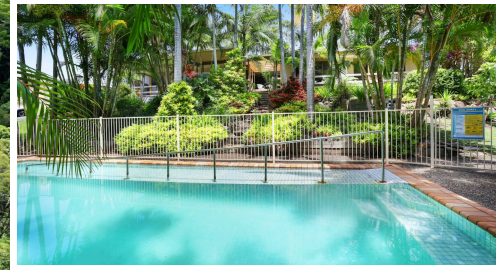

FOR SALE

SOLD IN DAYS BY AUDREY GOETZ! MORE URGENTLY NEEDED!

Over 1 acre of usable land with Ideal Location! Nestled in the heart of Mudgeeraba, this private tropical retreat offers the ideal blend of space, peace and convenience, with Robina Town Centre and major local schools just minutes away. Designed by the original architect-owner in 1982, this thoughtfully crafted 348m² home is slightly elevated to capture the refreshing Easterly ocean breezes and views of the Reserve and wildlife corridor. The spacious property is a true sanctuary, purposefully created as a respite space for both relaxation and accessibility. Immaculately presented and lovingly maintained, this property ticks so many boxes for comfort, space, privacy, and flexibility with an amazing location! The spacious, East-facing deck and veranda offer generous space for both relaxation and entertaining, while the sparkling North/East-facing pool is designed with special needs accessibility in mind, complete with a ramp.

The home is equipped with features to accommodate wheelchairs and has ramps for ease of access, making it ideal for the elderly or those with special needs. The spacious floor plan is also perfectly suited for dual living or the conversion of a Granny flat, with a generous bathroom that is already wheelchair accessible.

Whether you are seeking a peaceful haven, a functional multigenerational home or a work from home space, the ideal floorplan offers endless possibilities to create a home tailored to suit your lifestyle!

- ✓ 4632m² (over 1 acre) of usable land on a corner block - Acreage living at it's best with huge potential
- ✓ Multigenerational Dual living / Easy Granny flat conversion or work from home space in the existing property
- ✓ Possibility with lots of space to still build a seperate 80m² granny flat (subject to council approval)
- ✓ 5- 6 Bedrooms most with wheelchair access
- ✓ 3 spacious bathrooms with wheel chair access and facilities
- ✓ Central and spacious open plan kitchen with stone bench tops
- ✓ Spacious and generous East facing deck/ veranda with multiple spaces to relax and entertain
- ✓ Immaculately presented, just move in, renovate, invest and rent out or ideal holiday home

6 BED | 3 BATH | 2 CAR

PRICE:

Offers over \$1,750,000

OPEN FOR INSPECTION:

N/A



Audrey Goetz

0412148078

audrey@atrealty.com.au

www.atrealty.com.au

2 Tanby Court, Mudgeeraba

5/6 3 2 4,632 m²
 internal: 240 m² | external: 108 m² | total: 348 m²

@realty
 Audrey Goetz 0412 148 078

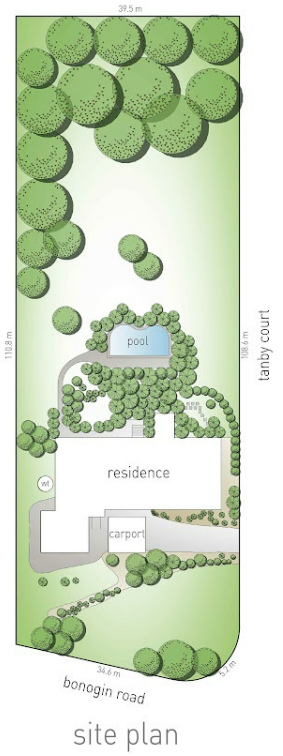
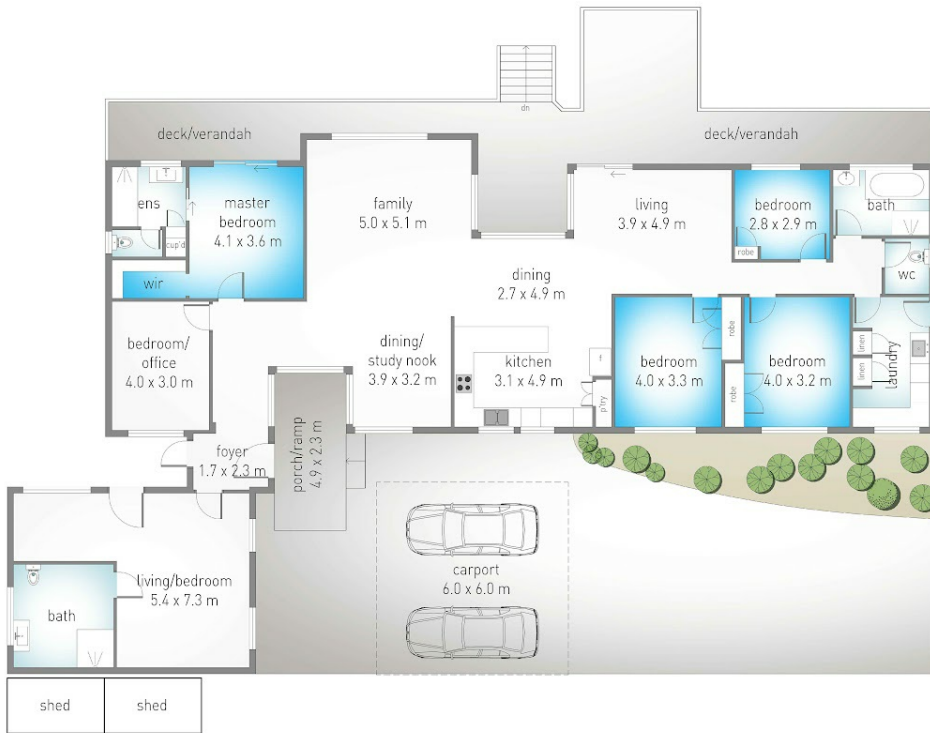

Dimensions are approximate. All information contained herein is gathered from sources we believe to be reliable. However we cannot guarantee its accuracy and interested persons should rely on their own enquiries. north

Disclaimer: Please note this floor plan is for marketing purposes and is to be used as a guide only. All dimensions are estimates only and may not be exact measurements.

Audrey Goetz
 0412148078
 audrey@atrealty.com.au
www.atrealty.com.au

