

**SOLD**

## EXCEPTIONAL VALUE PROPOSITION FOR INVESTORS AND OWNER-OCCUPANTS ALIKE.

Uncover a residence full of possibility that seamlessly blends contemporary luxuries with a peaceful ambiance. Nestled within a tranquil community, this home boasts a variety of amenities ideally suited for both investors and potential homeowners eager to settle into a cozy living space just a stroll away from the beaches and shops. With a touch of care, the functional floor plan and robust brick construction on a 714 sqm block could transform into an outstanding investment or a wonderful family home.

The expansive open-plan kitchen and dining area is bathed in natural light from the northern sun that pours in through the large picture windows and sliding doors, which lead to a secluded patio. Whether you're a frequent chef or an occasional cook, this thoughtfully designed kitchen offers ample cupboard space to accommodate all your culinary requirements.

The primary bedroom boasts an en-suite bathroom and a generous walk-in closet, offering a personal sanctuary for its inhabitants. Two more bedrooms are equipped with built-in closets and share a separate family bathroom. The living area is enhanced by a ceiling cassette reverse cycle air conditioning system and a wood heater, guaranteeing a cozy environment year-round.

A shaded outdoor entertainment space offers a perfect backdrop for hosting gatherings or indulging in outdoor leisure, harmoniously connected to the main residence. Furthermore, this property features solar panels and a North orientation, a sustainable upgrade that significantly reduces energy costs while fostering environmental stewardship.

The location of this property offers a strategic advantage, being just a short walk away from the stunning Inlet beach and the charming township, both easily reachable on foot. This property represents an excellent opportunity for both potential investors and homebuyers. Don't miss the chance to secure this competitively priced property and make the most of its numerous benefits and future possibilities.

**3 BED | 2 BATH | 2 CAR**

**PRICE:**  
\$700,000

**OPEN FOR INSPECTION:**  
N/A



**Leo Edwards**  
**0472523445**  
leo@atrealty.com.au  
[www.atrealty.com.au](http://www.atrealty.com.au)

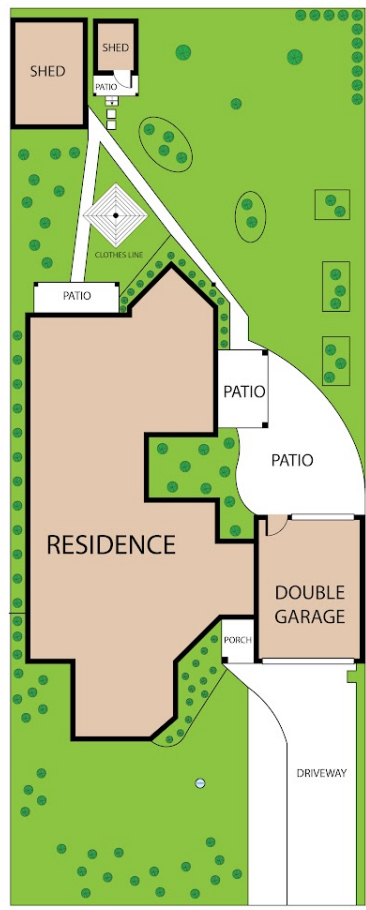
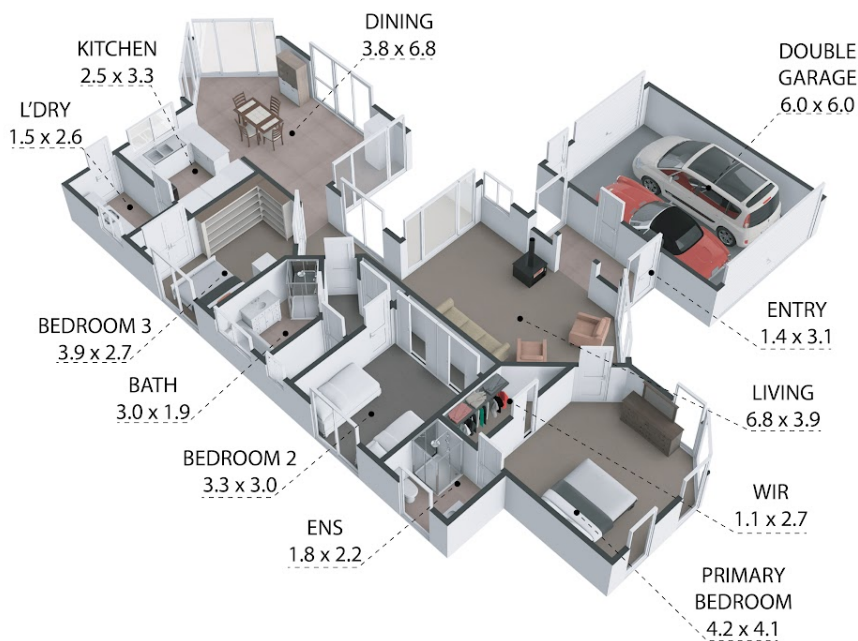

7 Heather Grove, Inverloch, VIC, 3996  
TOTAL APPROX. FLOOR AREA 149 SQM  
Whilst every attempt has been made to ensure the accuracy of the floor plan contained here, measurements of doors, windows, rooms and any other items are approximate and no responsibility is taken for any error, omission, or misstatement. This plan is for illustrative purposes only and should be used as such by any prospective purchaser.



Disclaimer: Please note this floor plan is for marketing purposes and is to be used as a guide only. All dimensions are estimates only and may not be exact measurements.

**Leo Edwards**  
0472523445  
leo@atrealty.com.au  
www.atrealty.com.au

