

2 /577 MAIN ROAD STOKE,
STOKE, NELSON, **NELSON / TASMAN**



FOR SALE

A SMART START

2  | 1  | 1 

The perfect starter or downsize option, this centrally located rear unit in Stoke is sunny, comfortable and affordable.

The home enjoys superb natural light creating a cosy atmosphere in the kitchen and living area which look out onto the private and fully fenced, surprisingly large backyard. Here you'll find a bonus studio shed which is perfect for the hobbyist or simply provides an extra storage or play room.

The single garage also includes a small workshop area with plenty of storage and there is extra off street parking available for vehicles.

Walk across the road to the supermarket and shops and it's only 5 minutes either way to Richmond or town making it an easy commute for work. Whether you're starting up on your property journey, downsizing to release capital and enjoy your retirement, or anywhere in between, this makes a smart move.

Contact Ben to view your new home today.

Ben Cooper | 0212557751 | ben@changerealestate.co.nz | changerealestate.co.nz

2 /577 MAIN ROAD STOKE,
STOKE, NELSON, **NELSON / TASMAN**

PRICE: Enquiries Over \$575,000

OPEN FOR INSPECTION: N/A

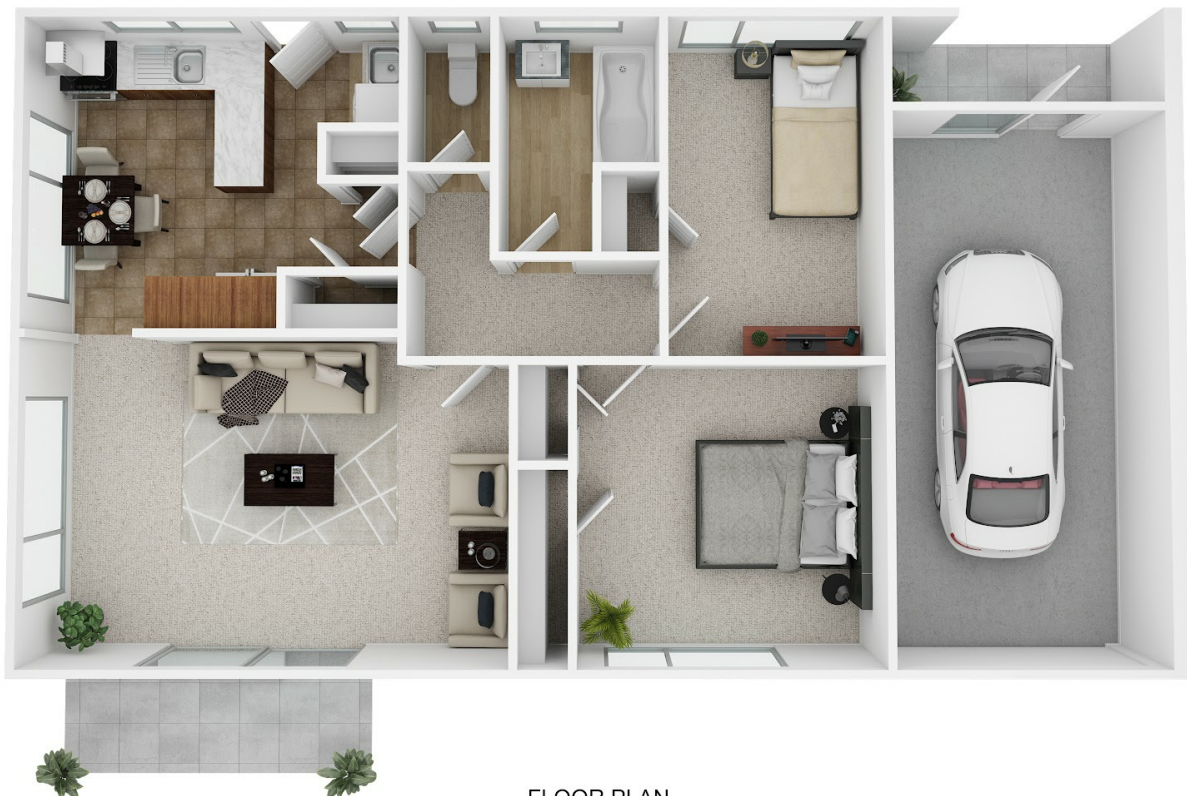

FLOOR PLAN

2/577 Main Road Stoke

This floor plan including furniture, fixture measurements and dimensions are approximate and for illustrative purposes only. Boxbrownie.com gives no guarantee, warranty or representation as to the accuracy and layout. All enquiries must be directed to the agent, vendor or party representing this floor plan.

Disclaimer: Whilst every effort has been made to ensure the accuracy of these particulars, no warranty is given by the vendor or the agent as to their accuracy. Interested parties should not rely on these particulars as representations of fact but must instead satisfy themselves by inspection or otherwise. (Rev NZ#1)

Ben Cooper | 0212557751 | ben@changerealestate.co.nz | [changerealestate.co.nz](https://www.changerealestate.co.nz)