



FOR SALE

FANTASTIC RENOVATED 5TH LEVEL APARTMENT WITH VIEWS TO THE HINTERLAND

You'll enjoy Broadwater living at its best in this contemporary apartment that offers fantastic views to The Hinterland. Silvershore is situated opposite the sandy Broadwater foreshore. This modern apartment is flooded with natural light.

Added extra storage through the apartment making it very liveable. The sleek, white entertainer's galley kitchen has ample storage with extra cupboards and work surface installed so you have more prep space than the other apartments in the building, mirrored splash-backs, stainless steel appliances and gas cooktop.

The spacious, light and bright open plan living/dining area also has built in storage and extra-large, floor to ceiling, full width patio doors that stack back to give the indoor/outdoor feeling that the Gold Coast lifestyle is all about and lead straight out to the private, extra-large 19m2 balcony that's an extra living room. Ideal for entertaining or to simply sit back, relax with a glass of wine and enjoy the sunset views. External aluminium shutters have been installed, so the balcony can truly become a 365 days of the year space.

The Master bedroom looks over the living area, through glazed shutters, to the Hinterland beyond and has triple, mirror fronted, built in robes and a 2-way en-suite bathroom. The 2nd bedroom/study/multi-purpose room has obscured sliding doors so can easily be used as a bedroom for your occasional guest. Extra storage has been added here too.

The 2 way bathroom has been updated with a walk-in shower with full height glazed shower screen.

This modern apartment is positioned in Silvershore on Marine Parade with direct access to the Broadwater, walkways and parks and is only a stroll to restaurants and cafes, amenities and shops. Easy access to Griffith University, Gold Coast University Hospital, and Runaway Bay Shopping Centre and Harbour Town for outlet shopping.

The majority of Silvershore apartments are owner occupied or permanent tenancies, with only about 23 apartments in the holiday pool. The perfect apartment for home or investment. You can stay when it suits you and holiday let it when you want or live in or rent out permanently - the choice is yours.

1 BED | 1 BATH | 1 CAR

PRICE:
SOLD

OPEN FOR INSPECTION:
N/A



Francine Setchell
0408143464
francine@atrealty.com.au
www.atrealty.com.au

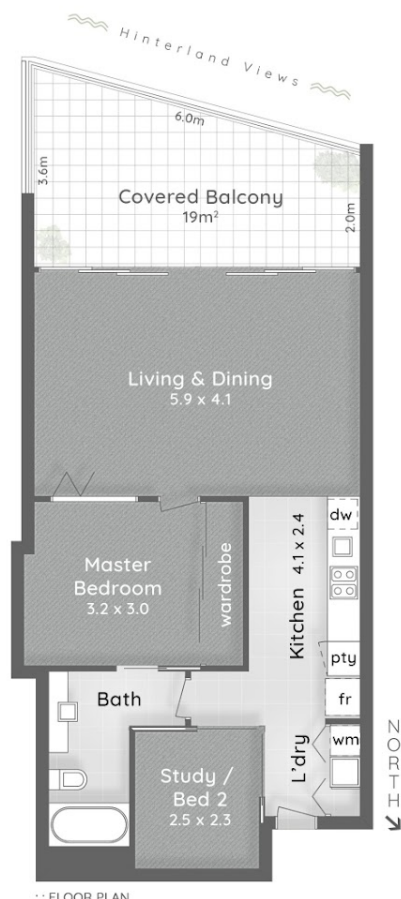

:: FLOOR PLAN

POINTS OF INTEREST

1. SILVERSHORE
2. Harbour Town Outlet Shopping
3. Metro Market | 4. Quota Park
5. Harbourside Market
6. Biggera Waters Creek
7. Labrador Park Shopping Centre



:: LOCATION MAP

SILVERSHORE

430 Marine Parade
BIGGERA WATERS

2 Bed

1 Bath

1 Car

Internal 67m²

Balcony 19m²

Total 86m² or 9 Squares

puredesign plans for
CONCEPTS purpose

This is not a legal document therefore all measurements and information provided is subject to survey. No permission is given to use or alter this Floor Plan without the consent of Pure Design Concepts. The overall presentation style, layout, imagery, fonts, background, colours and terminology has been originally created by PDC and is subject to strict copyright. No ownership is taken of building design. Find out more at puredesignconcepts.com.au

Disclaimer: Please note this floor plan is for marketing purposes and is to be used as a guide only. All dimensions are estimates only and may not be exact measurements.