



FOR SALE

SOLD BY ROSS HINCKSMAN WATER VIEWS WHILST LIVING IN PARADISE - RARE 3- BEDROOM 2 BATHROOM BRIBIE ISLAND UNIT

Discover coastal living at its finest in this stunning three-bedroom unit, perfectly positioned to capture the beauty of Pumicestone Passage in sought-after Bongaree, Bribie Island. This contemporary residence offers an enviable blend of comfort, convenience, and seaside charm.

Bongaree's location offers an exceptional lifestyle opportunity on beautiful Bribie Island. The suburb sits at the gateway to the island, being the first community you reach after crossing the iconic Bribie Bridge. This positioning provides easy access to the mainland while maintaining the relaxed island atmosphere that makes Bribie so special.

Key Features:

- Three bedrooms - Master with walk-in-robe: 2 with built-in wardrobes
- Two bathrooms including master ensuite
- Modern kitchen with dishwasher
- Air conditioning for year-round comfort
- Secure parking with single garage
- Private balcony perfect for outdoor living
- Broadband internet connectivity
- New carpets in all 3 bedrooms
- Freshly painted throughout with feature walls
- Electronic outdoor blinds x 3
- Blockout pull down blinds (internal) to balcony door
- Crimsafe screens to all balcony doors
- Crimsafe security door to entrance door
- Black aluminium shutters to all doors and windows
- Fanaway fan to main bedroom
- Renovated bathroom
- New shower screen to ensuite
- Downlights to living room and bedrooms
- New fashionable light fittings over kitchen bench
- New 2 drawer dishwasher

3 BED | 2 BATH | 1 CAR

PRICE:

offers above \$850,000

OPEN FOR INSPECTION:

N/A



Ross Hincksmann

0417687379

rossh@atrealty.com.au

www.atrealty.com.au

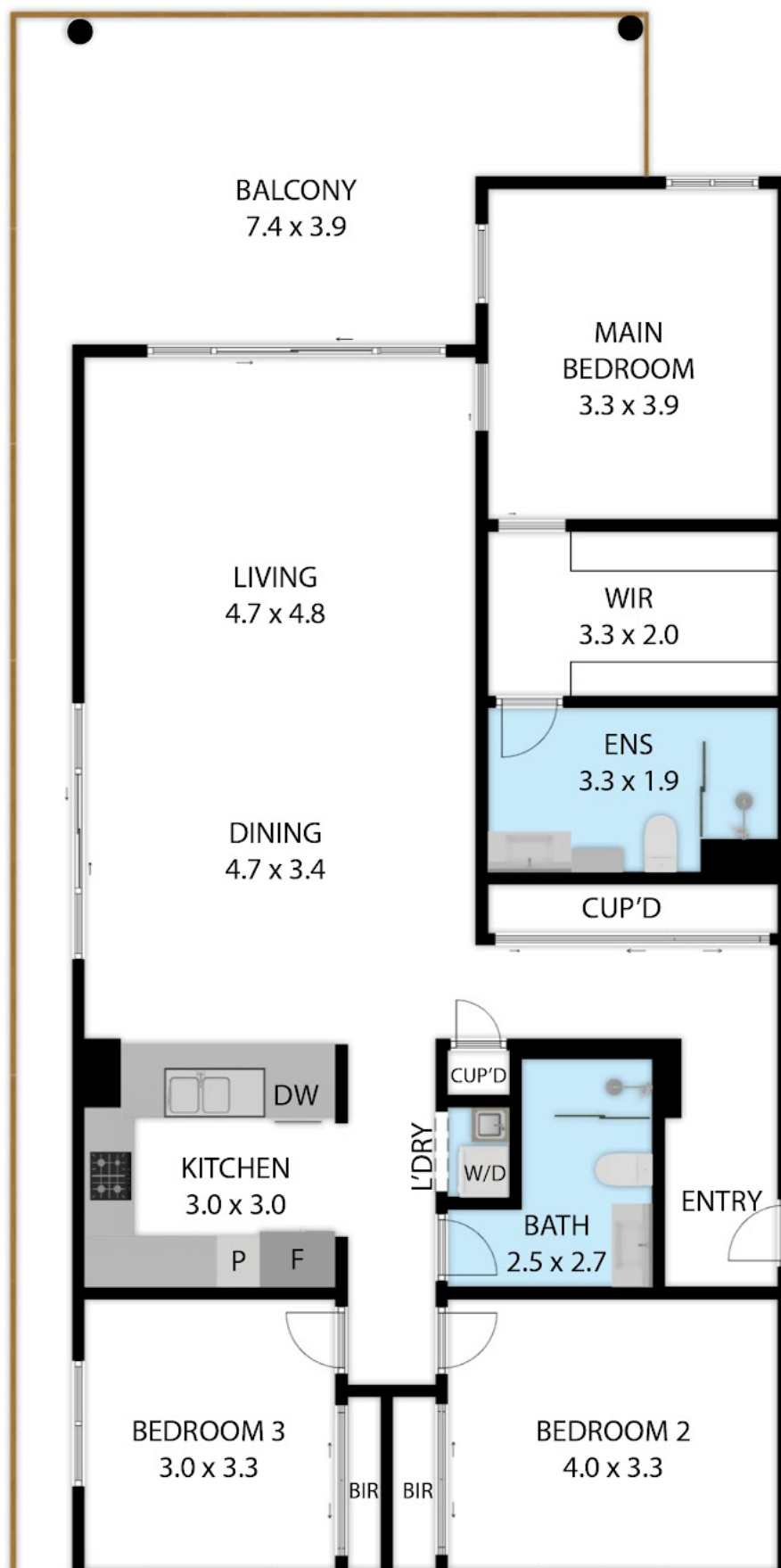

Disclaimer: Please note this floor plan is for marketing purposes and is to be used as a guide only. All dimensions are estimates only and may not be exact measurements.

TOTAL APPROX. FLOOR AREA 117 SQ.M

Whilst every attempt has been made to ensure the accuracy of the floor plan contained here, measurements of doors, windows, rooms and any other items are approximate and no responsibility is taken for any error, omission, or misstatement. This plan is for illustrative purposes only and should be used as such by any prospective purchaser.