



FOR SALE

LIGHT-FILLED & RENOVATED WITH SPACE TO ENTERTAIN

Nestled in the sought-after Bellbridge Estate, this beautifully renovated home offers the perfect blend of contemporary style and family-friendly charm. Freshly updated, this stunning three-bedroom residence is ready for its next owners. Whether you're a first-home buyer, investor, or growing family, this home has space for everyone!

Step inside to discover a bright and inviting interior, where natural light floods through large windows, highlighting the brand-new flooring and stylish modern finishes. The expansive living areas provide plenty of room to relax or entertain, while the sleek kitchen features a brand-new dishwasher, rangehood, and ample bench space—perfect for family dinners.

The master bedroom serves as a private retreat, complete with a walk-in robe and ensuite, while the additional bedrooms ensure comfort for the entire family. Both bathrooms have been fully renovated with contemporary fittings and elegant finishes, adding a touch of luxury to everyday living. Heating and cooling guarantee year-round comfort, while the generous laundry and separate toilet add to the home's practicality.

Outside, the property continues to impress with a double garage and a well-sized yard, offering plenty of potential for outdoor entertaining or a play area for kids and pets.

Perfectly positioned for families, this home is moments from top local schools, including Bellbridge Primary, Hoppers Crossing Secondary, Westbourne Grammar, and Al-Taqwa College. Enjoy the convenience of nearby shopping at Wyndham Village, Hoppers Crossing Centre, and Pacific Werribee, with easy access to public transport and major roads.

Don't miss out on this fantastic opportunity—secure your place in Bellbridge today! Call now to arrange an inspection.

3 BED | 2 BATH | 2 CAR

PRICE:

\$630,000 - \$660,000

OPEN FOR INSPECTION:

N/A



Samuel Hogan

0401315234

samuel@atrealty.com.au

www.atrealty.com.au

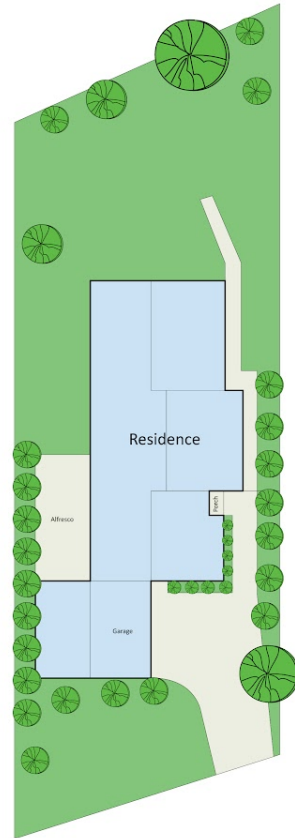

46 Coolabah Crescent, Hoppers Crossing

Dimensions are approximate and for illustrative purposes only



Disclaimer: Please note this floor plan is for marketing purposes and is to be used as a guide only. All dimensions are estimates only and may not be exact measurements.