



FOR SALE

YANDINA 2BDRM DUPLEX, READY TO MOVE IN OR INVESTMENT OPPORTUNITY...

2 BED | 1 BATH | 1 CAR

unit 2/4 Reo Place, Yandina, QLD, 4561

Just listed and certain to please, corner Duplex, Unit 2/4 REO Place, Yandina is available to purchase, the current tenants are vacating at the end of April, 2025, so ideal if your looking for an affordable forever home to move into or an ideal Investment with current tenants paying \$500.00 per week, we can arrange new tenants by settlement if needed.

- ~ Light, bright, contemporary 2 bedroom, 1 bathroom Home.
- ~ Fully fenced Courtyard, ideal if you have pets.
- ~ Single remote garage.
- ~ Modern bathroom.
- ~ Reverse cycle air conditioning with heating and cooling for all year comfort.
- ~ Walk to the popular Yandina markets to stock up on fresh produce and enjoy the atmosphere.
- ~ Central to local Yandina shops and schools.
- ~ 15min drive to the best beaches on the Sunshine Coast or upto the Sunshine Coast Hinterland to explore.
- ~ Just over an hour drive to Brisbane with easy access to the highway.

PRICE:

SOLD \$685,000

OPEN FOR INSPECTION:

N/A



Vanessa Brunton

0467 448 850

vanessa@vbrealestate.com.au

www.vbrealestate.com.au

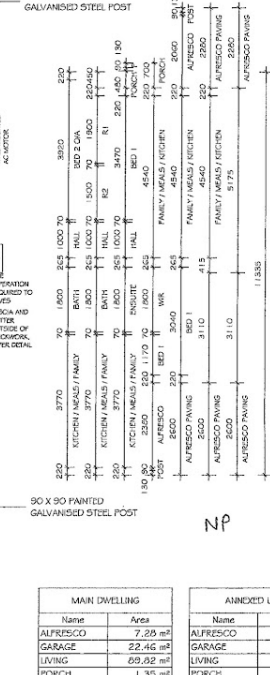
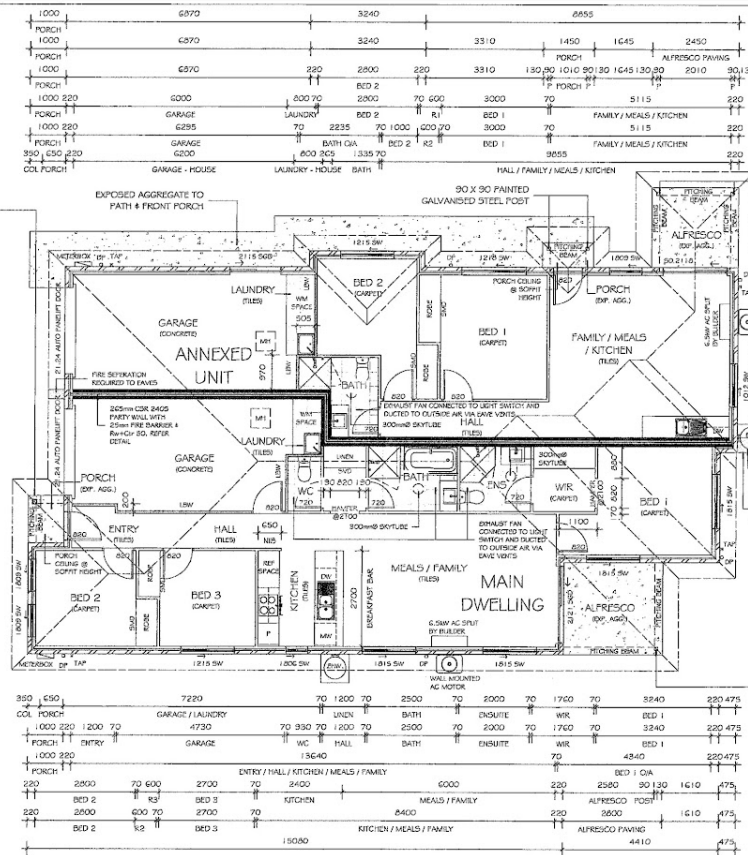
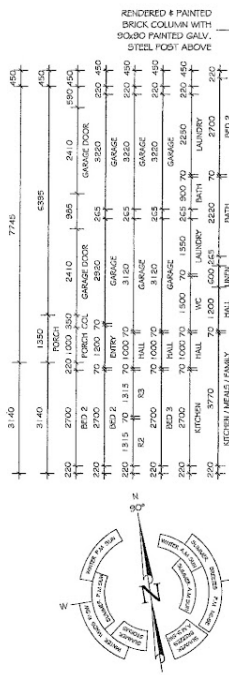

MAIN DWELLING		ANNEXED UNIT	
Name	Area	Name	Area
ALFRESCO	7.26 m ²	ALFRESCO	5.59 m ²
GARAGE	22.46 m ²	GARAGE	24.61 m ²
LIVING	69.92 m ²	LIVING	35.77 m ²
PORCH	1.35 m ²	PORCH	1.02 m ²
Total	120.91 m ²	Total	91.10 m ²



No.	Description	Date

ISSUE FOR ENGINEERING
DATE: _____ SIGNED: _____
ISSUE FOR CONSTRUCTION

COMBINED FLOOR AREA
ALFRESCO 12.67 m²
GARAGE 47.27 m²
TOTAL 59.94 m²

FLOOR PLAN

CD2

CLIENT NAME: _____
ADDRESS: _____

Disclaimer: Please note this floor plan is for marketing purposes and is to be used as a guide only. All dimensions are estimates only and may not be exact measurements.

