

19 RIVERBREEZE CRESCENT
MAUDSLAND



REFRESH
REAL ESTATE



FOR SALE

SOLD BY ZOË GRIFFITHS | REFRESH REAL ESTATE

New Street Record 14/05/2025
Method of Sale: Private Treaty
Marketing Campaign: Targeted Digital and Print
Under Offer in: 4 Days

Thinking of selling? Don't settle for anything less than the best result for your sale and an agent 100% committed to seeing it through!

Call Zoë today | 0481 329 691

Welcome to 19 Riverbreeze Crescent. This beautiful spacious residence delivers the perfect blend of comfort and relaxed living. With an emphasis on entertaining, its highlights include soaring high ceilings and spacious open plan living and dining, multiple living spaces including a huge family theatre room, designated office space to keep work away from play, a gorgeous alfresco overlooking the sparkling saltwater pool, level lawn for children and pets and also features a cosy fire-pit with stunning hinterland views.

When you step inside you'll discover open plan living and dining areas that seamlessly flow from the indoors out, blending functionality with style. For moments of relaxation and entertainment, unwind in one of the multiple living areas, offering versatility and space for various activities. With four bedrooms and two bathrooms + powder room, including a master suite complete with an ensuite and walk-in robe. Comfort, luxury and privacy are paramount here.

Situated on an ample 630m2 reserve side location, this property offers a sense of exclusivity and tranquility. Its private and secure environment ensures peace of mind, while its location in a tightly held Crescent with only your neighbours driving by for the most part, which adds even more so to its desirability. Experience the epitome of contemporary living in this meticulously designed MEtricon residence, where every detail has been thoughtfully curated for discerning individuals seeking

4  | 2  | 4 

PRICE:
Sold by Zoë Griffiths | Refresh Real



Zoe Griffiths
0481329691

zoe@refresh.realestate
[Refresh Real Estate](#)



Zoe Griffiths
0481 329 691

PROPERTY DETAILS

Internal Area	228m ²
Garage	36m ²
External Area	22m ²
Total Area	286m ²
Land Area	630m ²



4



2



2

ENVISUAL DESIGN

Whilst every effort has been undertaken for 300% accuracy, Plans should not be relied on solely. All images/finishes are for illustrative purposes only and are intended to depict the general layout only. No plans/site plans represented are to scale. Areas have been rounded off where appropriate. Area calculations are based on third party calculations. Unauthorised use or modification of this plan is strictly prohibited without the explicit consent of Envisual Design.



Floor Plan

Legend

- 1. Driveway | 2. Entrance Porch
- 3. Double Garage | 4. Residence
- 5. Clothes Drying Patio | 6. Outdoor Lounge Patio
- 7. Water Tank and Pool Pump | 8. Swimming Pool
- 9. Outdoor Dining | 10. Firepit Patio

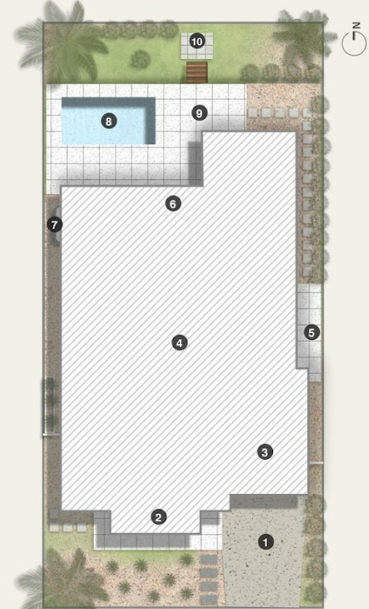

RIVERBREEZE CRESCENT

Site Plan

Disclaimer: Whilst every effort has been made to ensure the accuracy of these particulars, no warranty is given by the vendor or the agent as to their accuracy. Interested parties should not rely on these particulars as representations of fact but must instead satisfy themselves by inspection or otherwise.(Rev AU#2)