

17/8-10 SWAN ROAD, ATTADALE, WA, 615

eatonproperty



SOLD

OVERSIZED TERRACE, NORTH-EASTERLY SUN IN PRIME ATTADALE LOCATION

Price Guide:
Suit Buyers Over \$575,000

End Date Sale
Offers close 4pm Monday 23rd June 2025 (unless sold prior)

Enquire:
DON'T WAIT FOR A HOME OPEN - Click "Get in Touch" or "Enquire" to be one of the first to view this property, prior to a Home Open.

OVERSIZED TERRACE, NORTH-EASTERLY SUN IN PRIME ATTADALE LOCATION

It's rare to find an apartment that offers this level of indoor-outdoor living, but this first-floor gem delivers in spades. The hero of the home is undoubtedly the expansive, north-east facing terrace – seamlessly connected to the living area via bifold doors, it's an entertainer's dream. Complete with a low-maintenance garden, this private and peaceful outdoor space is perfect for morning coffees or weekend barbecues, offering versatility and volume seldom found in apartments at this price point.

Inside, the two-bedroom, one-bathroom layout is thoughtfully designed, with solid timber floorboards providing warmth, character, and continuity throughout. The custom-made TV wall unit adds a stylish and functional focal point to the living area, enhancing the modern feel. Both bedrooms feature built-in robes, while the generous laundry offers bonus functionality – think scullery or butler's pantry.

The wet areas have been stylishly renovated in recent years, making the property move-in ready, yet still allowing scope for future value-adding improvements and equity growth.

The apartment's has 2 car-bays and the lock-up-and-leave appeal adds an extra layer of convenience for busy professionals, downsizers, or frequent travellers.

All of this is set within the vibrant Attadale community, where cafés, shops, parks, and the river

2 BED | 1 BATH | 2 CAR

PRICE:
\$650,000

OPEN FOR INSPECTION:
N/A



Jarrad Eaton
0403267251

jarrad@eatonproperty.com.au
eatonproperty.com.au

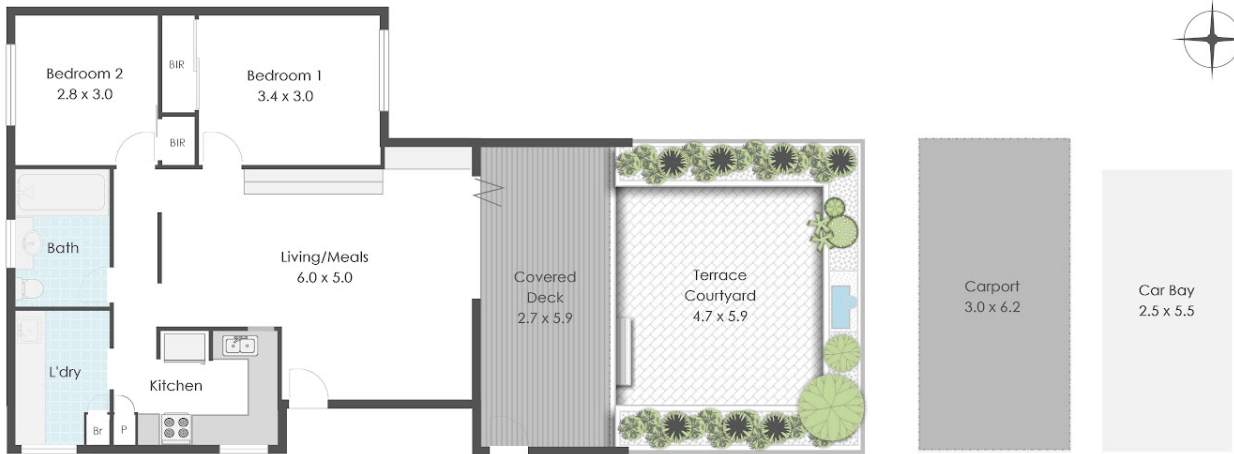

17/8-10 Swan Road, Attadale

Measurements are approximate, Representation Only
Please check dimensions on site.



Area Sizes approx
Residence: 68m²
Deck: 16m²
Terrace Courtyard: 23m²
Carport: 18m²
Car Bay: 14m²
Total: 144m²

Disclaimer: Please note this floor plan is for marketing purposes and is to be used as a guide only. All dimensions are estimates only and may not be exact measurements.