



FOR SALE

SOLD! FOR \$637,500 RECORD PRICE FOR EAGLEBY! SELLING? CALL MARUF 0469661761

Special Features

- Generously sized open-plan living and dining area
- Double lock-up garage with internal access
- 9kw solar system for significant energy savings
- 1,000L rainwater tank to reduce water bills
- Smart internal lighting system
- Private courtyard – perfect for entertaining or relaxing
- Set within a secure, highly maintained spacious gated complex with swimming pool.

Key Features

- 3 spacious bedrooms with built-in robes
- Master bedroom with ensuite and walk-in wardrobe
- 2 modern bathrooms + extra toilet & laundry downstairs
- Well-appointed kitchen with dishwasher and ample storage
- Air conditioning in main living area & master bedroom and ceiling fans in the bedrooms.

Property Description

Welcome to this beautifully maintained and modern townhouse located in a highly sought-after Eagleby complex. Whether you're looking for a first home, a downsizer's retreat, or a high-performing investment, this property ticks all the boxes.

Alongside its spacious design and quality finishes, this home includes a 9kw solar power system and a 1,000L water tank, helping you cut down on energy and utility costs while living more sustainably.

Boasting three generous bedrooms, two bathrooms, and a double garage, the home provides plenty of space for families, professionals, or tenants. The light-filled interiors and thoughtful layout make for relaxed, low-maintenance living.

Amenities Nearby

- Eagleby Shopping Plaza – just minutes away
- Beenleigh Marketplace & Train Station – 7 mins drive

3 BED | 2 BATH | 2 CAR

PRICE:

Offers over \$629,000

OPEN FOR INSPECTION:

N/A



Maruf Ahmed

0469661761

maruf@atrealty.com.au

www.atrealty.com.au

3  2  2 

Internal Area: 124m²
 External Area: 35m²
 Total Area: 159m²

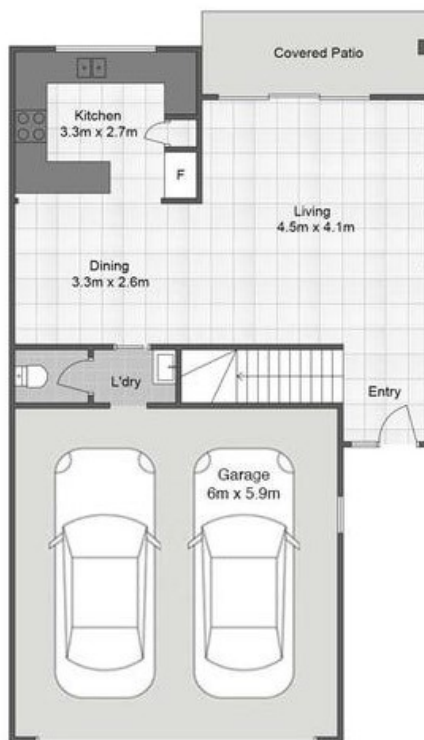

Ground Floor



First Floor

Whilst every attempt has been made to ensure the accuracy of the floor plan contained here, measurements of doors, windows, rooms and any other item are approximate and no responsibility is taken for any error, omission, or misstatement. This plan is for illustrative purposes only and should only be used as such by any prospective purchaser.

Disclaimer: Please note this floor plan is for marketing purposes and is to be used as a guide only. All dimensions are estimates only and may not be exact measurements.