



# SOLD

## LUXE LIVING, LEAFY OUTLOOK - AMPLE PARKING!

An elegant union of practicality and pleasure, this well-designed two-level home built circa 2023 delivers a luxuriously comfortable living experience.

Occupying the end position in a row of only three, it has a wonderfully private feel - and a pleasantly surprising amount of parking for a home in the high(er) density space!

Here are a few highlights that make this home a real standout:

**The Living: Stylish & Functional**

Living spaces on both levels enhance your feeling of space and, quite simply, give you options. Relax, cook and entertain on the ground floor in a modern, spacious open plan setting - flowing out nicely to north facing decking shaded by a luxe louvre gazebo. Older kids can Netflix and chill in the family room upstairs - while the gamer in the family utilises the study for their online adventures, their shouts of triumph softened by an enclosed space all their own.

**The Bedrooms: How will everyone choose?**

All good sized doubles. Of course, the master has a walk in robe and ensuite - plus fabulous sun. But the others have some really awesome features too. From a walk in robe, especially gorgeous elevated view - or direct access to the lovely deck downstairs. There are some cool options here for each member of your family.

**The Rest: The Detail, Leafy Outlook, Easy Location.**

Conventionally good looking from the outside, but unforgettable on the inside. The difference is in the detail. Wooden shutters, a touch of tinting in the right places, quality chattels - a soothing green outlook. It's fenced for your furry friends too. And the location close to Luckens Road makes getting to and from arterial routes heading north or south easy peasy.

Sound like you? Why wait for the Open Homes when you can book a private viewing? I look forward to showing you through.

4 BED | 3 BATH | 1 CAR

PRICE:  
\$1,085,000

OPEN FOR INSPECTION:  
N/A



**Maria Santayana**  
021454694  
maria@goodhaus.co.nz

Upper level

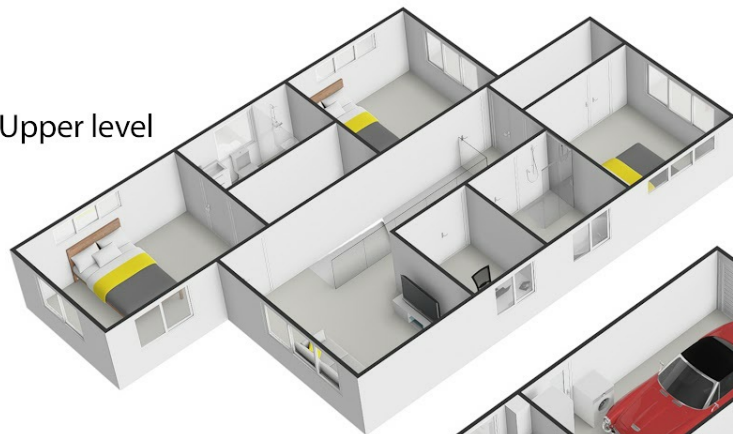

Lower level



**NORTHTOWEST** | @realty

Measurements are approximate, this plan is for illustrative purposes only and is not an exact representation of the property

Disclaimer: Please note this floor plan is for marketing purposes and is to be used as a guide only. All dimensions are estimates only and may not be exact measurements.

**Maria Santayana**  
021454694  
maria@goodhaus.co.nz

@realty