

2/127 MANNING ROAD, MANNING, WA, 6172

**eaton** property



**SOLD**

## AFFORDABLE MODERN COMFORT - MOVE IN READY!

### OPPORTUNITY

Don't be deterred by the address – this home is tucked away at the rear, well set back from Manning Road, offering surprising privacy, away from passing traffic.

### LOCATION

2/127 Manning Road, Manning

### PRICE GUIDE

Suit Buyers Early \$1,000,000s

### END DATE SALE

Offers close 4pm Monday 18 August 2025 (unless sold prior)

### ENQUIRE

DON'T WAIT FOR A HOME OPEN - Send an online enquiry (please no SMS) by clicking "Get in Touch" or "Enquire" to be one of the first to view this property, before a Home Open.

### AFFORDABLE MODERN COMFORT - MOVE IN READY!

Living in a rear home offers a unique sense of calm, a welcome escape from passing traffic and the busyness of the outside world. Driving down your private driveway into your own space is the ultimate reset for busy lives. It's quiet, secure, and completely yours, a private sanctuary.

Tucked away in a private rear position, this well-maintained and freshly painted home offers a winning combination of space, comfort and convenience for the modern family. Set on a 417sqm block and built in 2008, it's ideal for those seeking a low-maintenance, lock-and-leave lifestyle without compromising on functionality or flow.

The thoughtful floorplan provides excellent separation between the living zones and bedrooms, with two generous living areas to suit both relaxed family living and entertaining. The open-plan kitchen, dining and family area is the central hub of the home, flowing effortlessly through a sliding door to the outdoor entertaining space. A separate lounge offers the perfect setting for a

4 BED | 2 BATH | 2 CAR

PRICE:

\$1,230,000

OPEN FOR INSPECTION:

N/A



**Jarrad Eaton**

**0403267251**

[jarrad@eatonproperty.com.au](mailto:jarrad@eatonproperty.com.au)

[eatonproperty.com.au](http://eatonproperty.com.au)

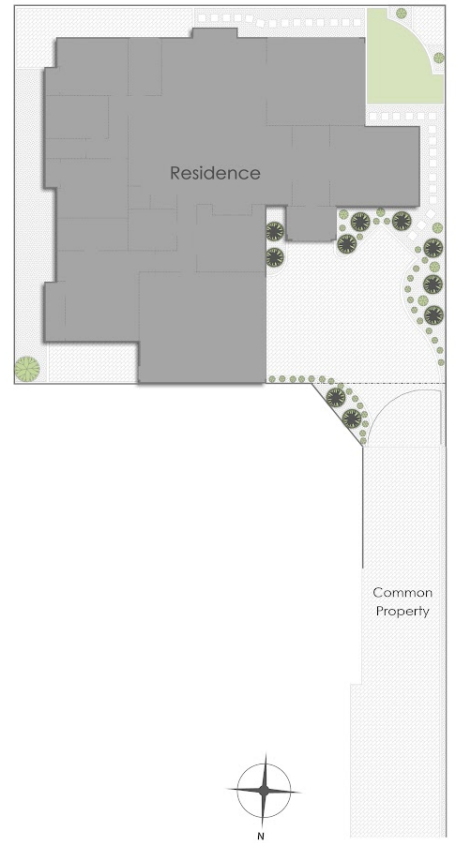

2/127 Manning Road, Manning

Measurements are approximate, Representation Only  
Please check dimensions on site.



Area Sizes approx  
Residence: 190m<sup>2</sup>  
Garage: 37m<sup>2</sup>  
Alfresco: 19m<sup>2</sup>  
Porch: 4m<sup>2</sup>  
Total: 250m<sup>2</sup>

Disclaimer: Please note this floor plan is for marketing purposes and is to be used as a guide only. All dimensions are estimates only and may not be exact measurements.

Jarrad Eaton  
0403267251  
jarrad@eatonproperty.com.au  
eatonproperty.com.au

