



SOLD

FULL SEMI DETACHED DUPLEX OPPORTUNITY -

This well-appointed Duplex is nearing completion of significant renovations, to create the perfect combined multi-dwelling home or investment opportunity. Each unit has a thoughtfully designed layout featuring two generous bedrooms. One with a BIR & wall mounted A/C, Bathroom and separate W/C. Both units provide ample accommodation for growing families or tenants with an open plan kitchen, lounge, dining area for casual living. The properties aspect captures natural breezes and the beauty of the surrounding landscape.

Earlville's gently rising terrain offers glimpses of the mountainous regions that characterise this picturesque suburb. Within walking distance of Stockland Cairns Shopping Centre, one of the region's premier retail destinations. The shopping centre houses everything from major retailers to specialty stores, plus essential services including the post office, public library, and police beat shopfront, ensuring all your daily needs are met nearby.

The suburb's rich heritage adds character to modern living. Today's Earlville successfully blends history with contemporary amenities and lifestyle opportunities. Don't miss this rare opportunity to join the Earlville community and enjoy the perfect combination of space, convenience, and natural beauty that defines this exceptional property in a highly sought after suburb.

FAST FACTS :-

- * Easy /Direct Access to unit from adjoining single carport
- * Large 609 sqm block
- * Separately water metered
- * Block Construction
- * Roof recently re-screwed
- * Beautifully renovated (Completion due Shortly)
- * Internal Laundry
- * Renovated Bathroom with shower & Separate W/C
- * Individually metered for electricity
- * Rental Appraisal \$550 - \$ 575 per week per unit
- * Rates \$6, 282.00 P/A

4 BED | 2 BATH | 2 CAR

PRICE:
\$850,000

OPEN FOR INSPECTION:
N/A



Sue Anderson
0402444084
sue@atrealty.com.au
www.atrealty.com.au

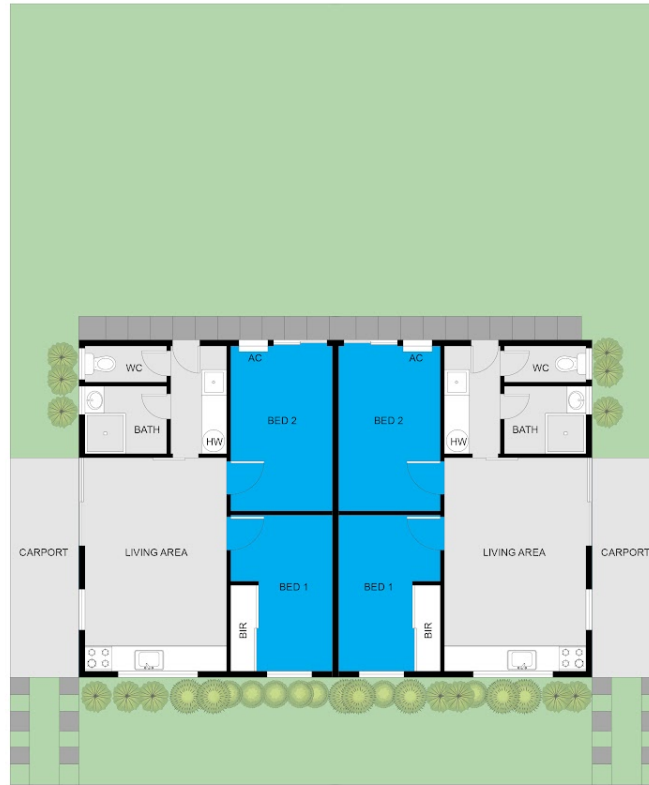

FLOOR PLAN ON SITE

This floor plan including furniture, fixture measurements and dimensions are approximate and for illustrative purposes only.
@Realty gives no guarantee, warranty or representation as to the accuracy and layout.
All enquiries must be directed to the agent, vendor or party representing this floor plan.

34 Mansfield St , Earlville

Disclaimer: Please note this floor plan is for marketing purposes and is to be used as a guide only. All dimensions are estimates only and may not be exact measurements.