



SOLD

GREAT HOME AT A GREAT PRICE!

Located at Cleveland Palms, the secure gated community, around 20 minutes South of Fairfield Central Shopping Center, is this block dwelling on a fully fenced 600 sq. m. block, that's ideal for those wanting an affordable property, or for those wanting a fantastic weekend getaway.

Inside is totally open with a full-size kitchen, bathroom and separate toilet and a living/bedroom that's currently sectioned off by a tarpaulin and joins a storage area and the double tandem garage.

Joining the residence is a huge carport that's over 11 metres long, 3 metres wide and 3 metres high, just ideal for your boat or caravan!

Other great features of this property are:

- Large front verandah,
- 6 metre shipping container,
- 2 large water tanks with pumps,
- 4 sq. m. garden shed,
- Septic system,
- 6 kw solar system,
- Gas instant hot water system and cooktop,
- Roller door shutters over the doorways,
- Dual double gate access.

Please note - The land at Cleveland Palms is leasehold, not freehold, therefore the usual small deposit bank finance is not available. The community is run by a body corporate with the annual fees of \$5090 which includes Council rates.

Cleveland Palms is a haven for those into fishing with an all-weather boat ramp and fishing platform, for the exclusive use of residents and their guests. The community also has a swimming pool, tennis courts, barbeque areas and a community centre for local get togethers.

Buyers looking for a solid home, with lots of extras, in a secure location, should check out what's on offer here.

Call and arrange an inspection.

1 BED | 1 BATH | 4 CAR

PRICE:
\$225,000

OPEN FOR INSPECTION:
N/A



Gerard Black
0426779633

gerardblack@atrealty.com.au
www.atrealty.com.au

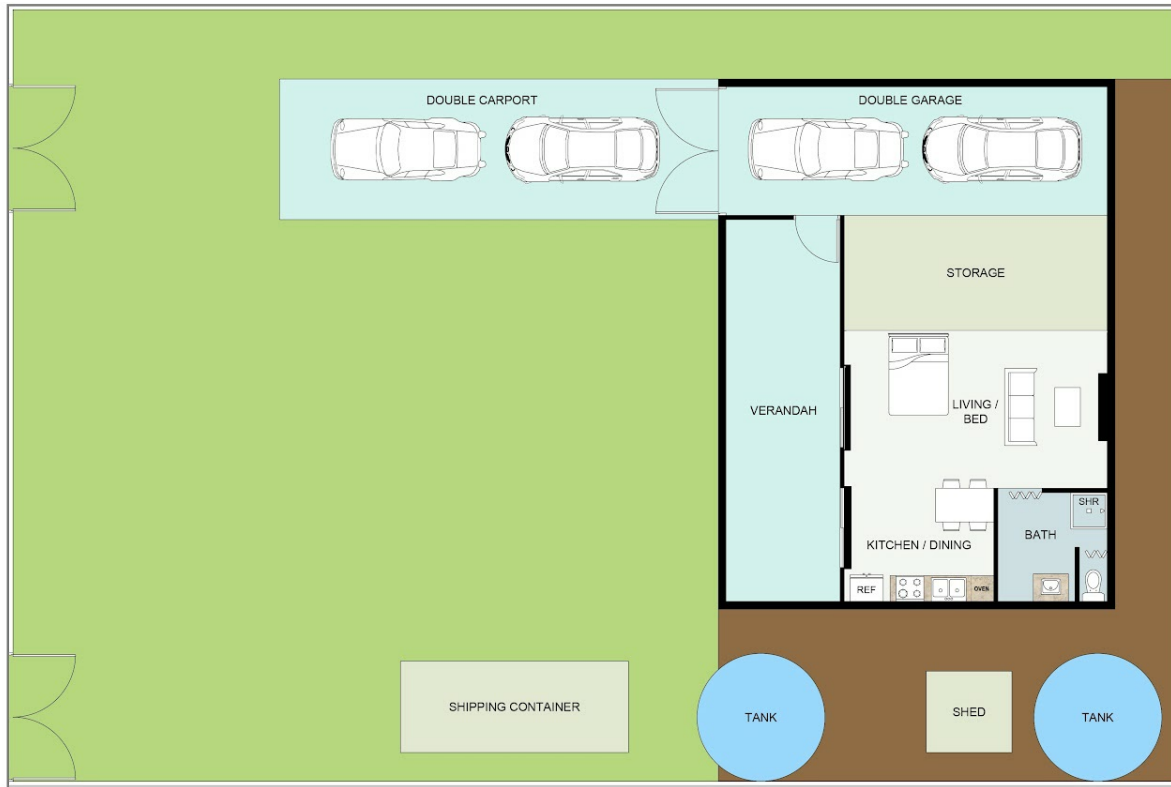

FLOOR PLAN ON SITE PLAN

This floor plan including furniture, fixture measurements and dimensions are approximate and for illustrative purposes only.
 BoxBrownie.com gives no guarantee, warranty or representation as to the accuracy and layout.
 All enquiries must be directed to the agent, vendor or party representing this floor plan.

13 Pavia Drive, Nome, Q, 4816.

Disclaimer: Please note this floor plan is for marketing purposes and is to be used as a guide only. All dimensions are estimates only and may not be exact measurements.