

22 MEADOW ROAD, REESVILLE, QLD, 4552



SOLD

PRICED REDUCED TO SELL - STUNNING BUSH VIEWS ON 2.2 ACRES

GRAY PROPERTY SERVICES would like to present this lovely home perched in the serene hills of Reesville, this charming 3-bedroom bush-view residence sits proudly on a sprawling 8,966 square meter block, offering an idyllic blend of country living and comfort. The property captures the essence of Queensland's sought-after indoor-outdoor lifestyle, with thoughtfully designed spaces that embrace the natural surroundings.

Step inside to discover a well-appointed home featuring polished floorboards throughout, creating a seamless flow between living spaces. The three bedrooms are generously sized, with built-in wardrobes providing ample storage solutions. Two full bathrooms ensure family harmony, while the spacious lounge room serves as the perfect gathering spot for relaxed evenings.

Features include:

- Master bedroom with his and her wardrobes, high raked ceilings with private deck and ensuite
- 2 bedrooms with built-ins
- Bathroom with separate toilet
- Open plan kitchen/dining/lounge with fireplace
- Solar hot water

The outdoor living spaces are truly exceptional, designed to make the most of Queensland's enviable climate:

- Expansive deck and balcony offering stunning bush views
- Covered outdoor entertainment area perfect for year-round gatherings
- Secure parking with additional workshop space
- Shed providing versatile storage options

This property represents the perfect opportunity to embrace the peaceful Reesville lifestyle, where a close-knit community of just over 570 residents calls home. The location offers the best of both worlds - rural tranquility with convenient access to modern amenities.

Just moments away, you'll discover:

- The scenic Howell's Knob Lookout, offering breathtaking panoramic views

3 BED | 2 BATH | 1 CAR

PRICE:
\$1,225,000

OPEN FOR INSPECTION:
N/A



Cassandra and Cameron Gray
0431316679
cgray@atrealty.com.au
www.atrealty.com.au

22 Meadow Road
Reesville

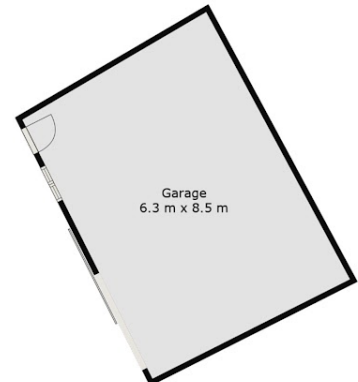
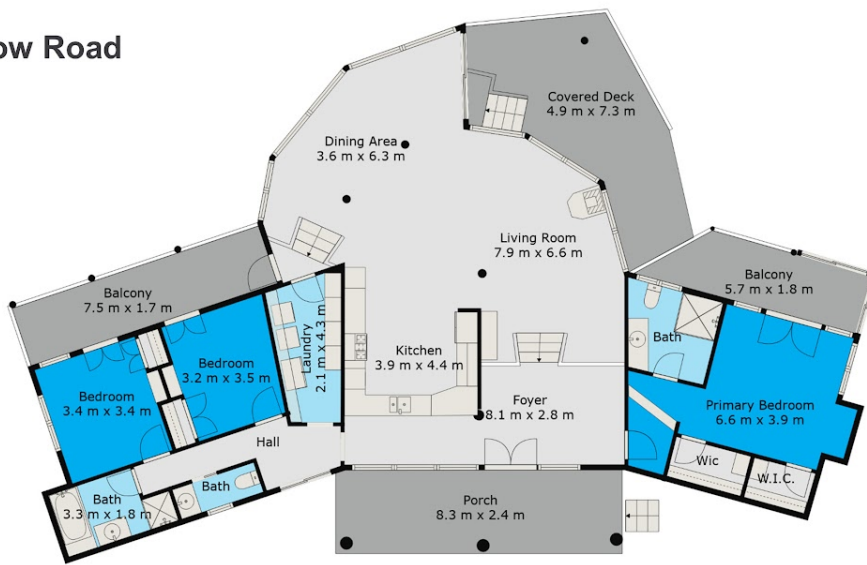

Internal Area	187	m2
Garage area	54	m2
External Area	57	m2
Approx Total Area	298	m2



Floor plan is for illustrative purposes only. All measurements are approximate and may vary. Buyers should verify details independently. No liability accepted for errors or omissions.



Disclaimer: Please note this floor plan is for marketing purposes and is to be used as a guide only. All dimensions are estimates only and may not be exact measurements.

