



SOLD

YOUR COASTAL CBD LIFESTYLE AWAITS

Welcome to 2b Mailey Pl, Lake Illawarra. This stunning two-story home is just 2.5 years old and combines modern elegance with central convenience. Featuring three spacious bedrooms, ducted air conditioning, stylish plantation shutters, hybrid flooring and easy-to-clean epoxy flooring in the garage. Comfort and convenience is a top priority in this home..

As you enter you are greeted by a bright and inviting open-plan living and dining area that seamlessly connects to a modern kitchen adorned in fresh white tones. This well-appointed kitchen features a gas oven and stovetop, dishwasher and a built-in pantry, all enhanced by sleek stainless steel appliances and a stylish stone-topped breakfast bar. Adjacent to the kitchen is the lux laundry with ample bench space and includes a convenient additional toilet. A door from this space leads out to a spacious covered outdoor alfresco area, perfect for relaxing or entertaining. Upstairs, you will find three spacious bedrooms, all equipped with built-in robes. The modern main bathroom features floor-to-ceiling tiles, while the master bedroom includes a walk-in robe that leads to a private, tucked-away ensuite

Conveniently located only minutes from Lake Illawarra's Reddal Reserve, Warilla Grove Shopping Centre, Stockland Shellharbour and your choice of amazing local beaches. Your Coastal CBD lifestyle awaits. Phone Peter Bullman today for more information.

3 BED | 2 BATH | 1 CAR

PRICE:
\$862,500

OPEN FOR INSPECTION:
N/A



Peter Bullman
0401394394
peterb@atrealty.com.au
www.atrealty.com.au

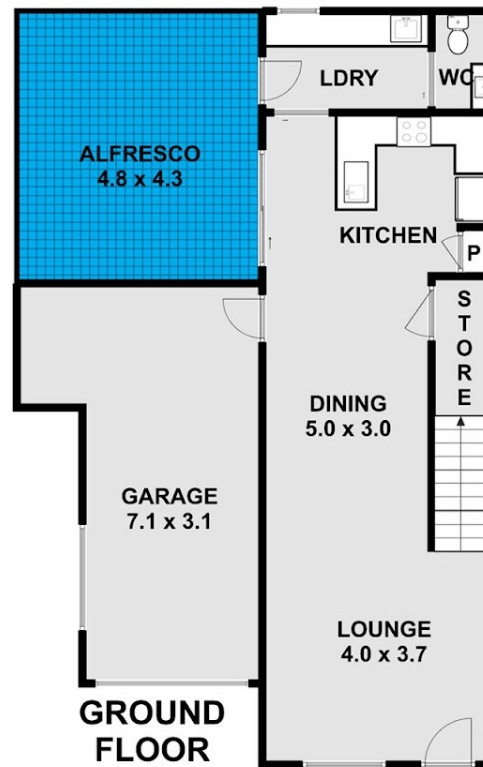
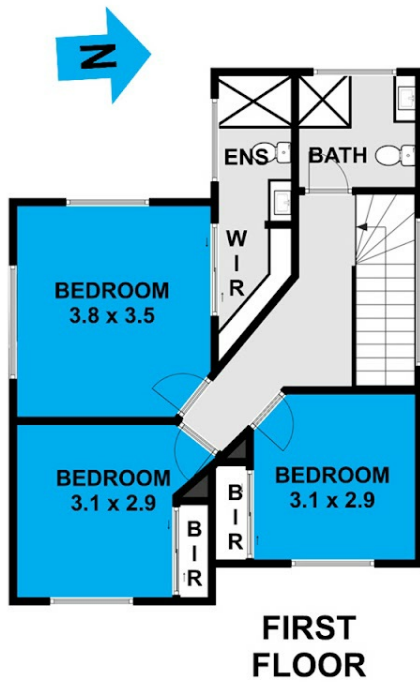

The floor plan including furniture, fixture measurements and dimensions are approximate and for illustrative purposes only.
@realty gives no guarantee, warranty or representation as to the accuracy and layout.
All enquiries must be directed to the agent, vendor or party representing this floor plan.

2B Mailey Place Lake Illawarra

Disclaimer: Please note this floor plan is for marketing purposes and is to be used as a guide only. All dimensions are estimates only and may not be exact measurements.