



# SOLD

## AFFORDABLE, SECURE AND SPACIOUS

Spacious & Well-Located Home – Ideal for First Home Buyers, Investors, or Downsizers

This well-positioned home in the sought after suburb of Dover Gardens presents an excellent opportunity whether you're entering the market, expanding your investment portfolio, or looking to downsize in comfort.

With a fresh neutral décor throughout, the home is ready to move in and enjoy or can easily be styled to suit your personal taste. The layout includes:

- 3 well-sized bedrooms, all with built-in robes
- Spacious living area with separate dining
- Generous kitchen featuring gas cooktop and dishwasher
- Centrally located bathroom with separate toilet
- Electric front gate's
- Private, secure rear yard

Garage under the main roof with roller door

Ideally located close to Westfield Marion, Flinders Medical Centre, Flinders University, schools, train station, and bus routes — everything you need is just minutes away.

Don't miss out – call Pete today on 0478 162 260.

3 BED | 1 BATH | 2 CAR

PRICE:  
\$825,000

OPEN FOR INSPECTION:  
N/A



**Pete Angel**  
**0478162260**  
pete@atrealty.com.au  
[www.atrealty.com.au](http://www.atrealty.com.au)  
RLA: 269823

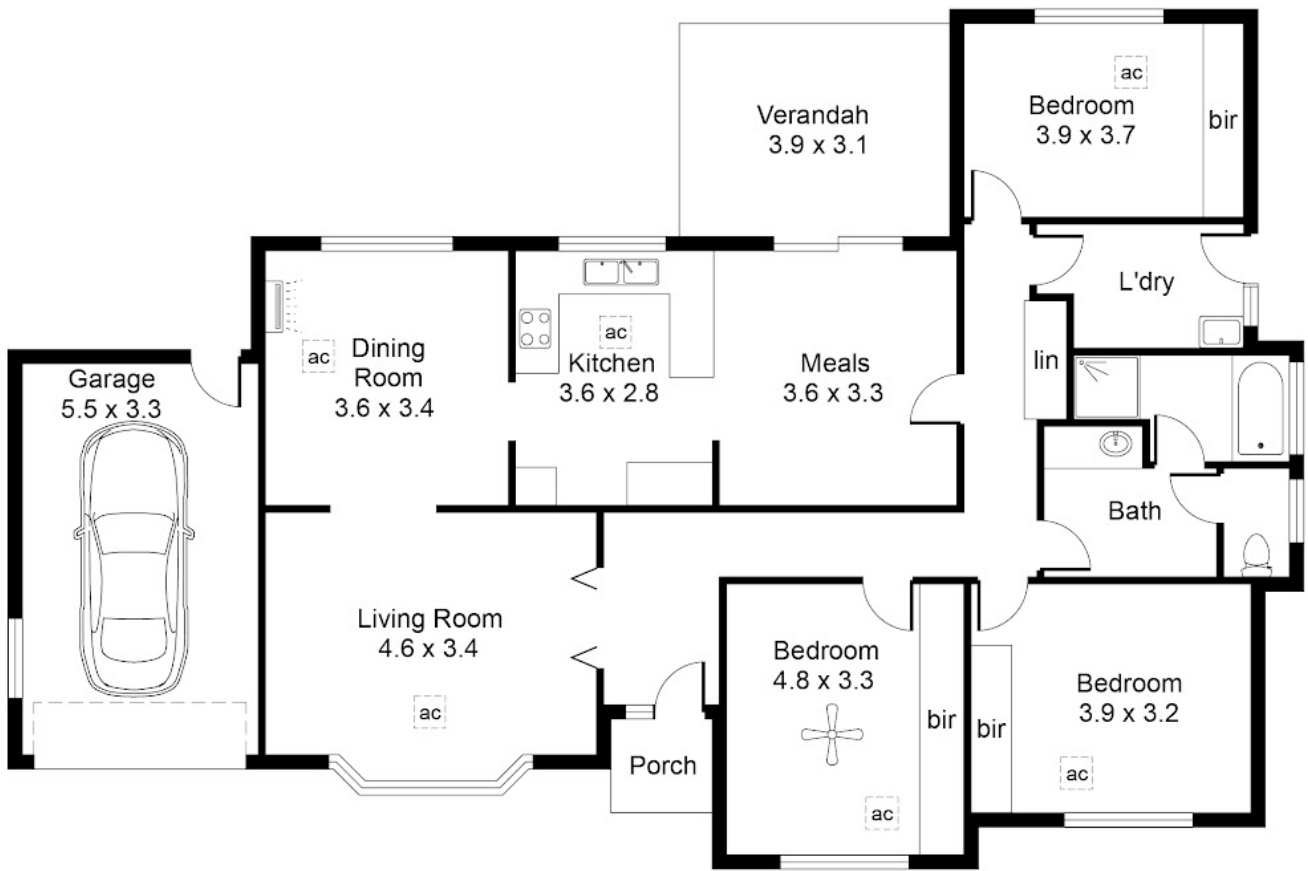

Disclaimer: Please note this floor plan is for marketing purposes and is to be used as a guide only. All dimensions are estimates only and may not be exact measurements.