

# LOT 28/10 HILLVIEW CRESCENT PAPARANGI

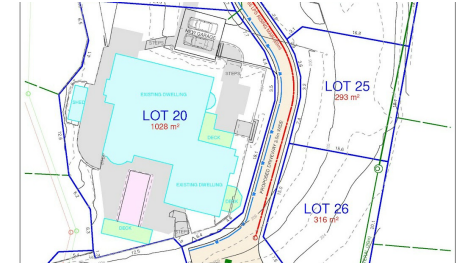

## FOR SALE

### HILLVIEW ESTATE - GATED COMMUNITY

Want to build your dream home? Look no further with the choice of 8 lots on offer in this exclusive gated subdivision.

With consent and work to start soon, look to secure your preferred lot now with as little as 5% deposit with stakeholder secure deposits and settlement once titles are issued around November 2025.

Paparangi is a progressive suburb nestled between Newlands and Johnsonville offering ease of commute and access to great local amenities. Just 10kms to the city, or take the train from Johnsonville.

A sunny outlook with privacy a key factor, you can secure from \$375,000 through to the larger sites at \$600,000.

#### Key Points:

- Only 8 lots available
- Single level and two story covenants
- Unobstructed outlook
- Gated exclusive subdivision
- North facing sites
- Design and build options also available as turn key packages
- Freedom to use your own preferred builder

#### Price Guide:

- Lot 21 - \$575,000
- Lot 22 - \$575,000
- Lot 23 - \$550,000
- Lot 24 - \$600,000
- Lot 25 - \$600,000
- Lot 26 - \$600,000
- Lot 27 - \$525,000
- Lot 28 - \$375,000

Get in touch with Mike now to arrange your viewing or see you at one of the open days onsite.

0 BED | 0 BATH | 0 CAR

#### PRICE:

Enquiries Over \$375,000

#### OPEN FOR INSPECTION:

N/A



**Mike Lovell**

**0274356007**

[mike@luxerealty.co.nz](mailto:mike@luxerealty.co.nz)

[www.luxerealty.co.nz](http://www.luxerealty.co.nz)