



SOLD

SPACIOUS LUXURY FAMILY HOME WITH DUAL LIVING POTENTIAL ON 1250M² WITH POOL, ENTERTAINING & DUAL SIDE ACCESS

DEVELOPMENT POTENTIAL FOR DUAL LIVING, ADD A GRANNY FLAT WITH COUNCIL APPROVAL OR LAND BANK FOR THE FUTURE. Cantt put a price on the Potential for this property it's open to so many value added scenarios. Come and have a look for yourself.

Nestled in the heart of Murrumba Downs, discover the perfect blend of comfort, space, and lifestyle in this impressive highset 5-bedroom, 3-bathroom brick home, set on a sprawling 1250m² block. Thoughtfully designed for relaxed family living and entertaining, this residence offers multiple living areas, a sparkling pool, and incredible outdoor feature, it's a rare opportunity in the heart of a thriving community. Move-in ready with nothing left to do!

An inspection WILL NOT disappoint

Key Features:

- * 5 Spacious Bedrooms
- * Master suite with ensuite and walk-in robe plus additional built-in cupboards
- * 4 additional bedrooms, (5th bedroom) makes an ideal Work from Home office/study
- * Multiple Living Spaces – Ideal for family flexibility and entertaining
- * 3 Spacious Bathrooms
- * Includes a master ensuite and 2 other bathrooms for family convenience
- * Highset Brick Construction Timeless appeal with elevated positioning for natural light and breezes
- * Freshly painted with new carpets, drapes, tracks, and plantation shutters throughout
- * Open-Plan Kitchen & Living – Centrally located kitchen with quality appliances, New stove and oven (1.5 years old) and great flow to living/dining, plus a huge covered outdoor area
- * Inground Pool
- * Perfect for family fun, easily viewed from the large covered entertaining area
- * Dual Side Access
- * Covered Side Access (4.5m x 12m) –host extra guests — versatile and secure to park multiple cars

5 BED | 3 BATH | 6 CAR

PRICE:
\$1,400,000

OPEN FOR INSPECTION:
N/A



Beverley Gibbons
0420807083
 beverley.gibbons@atrealty.com.au
www.atrealty.com.au

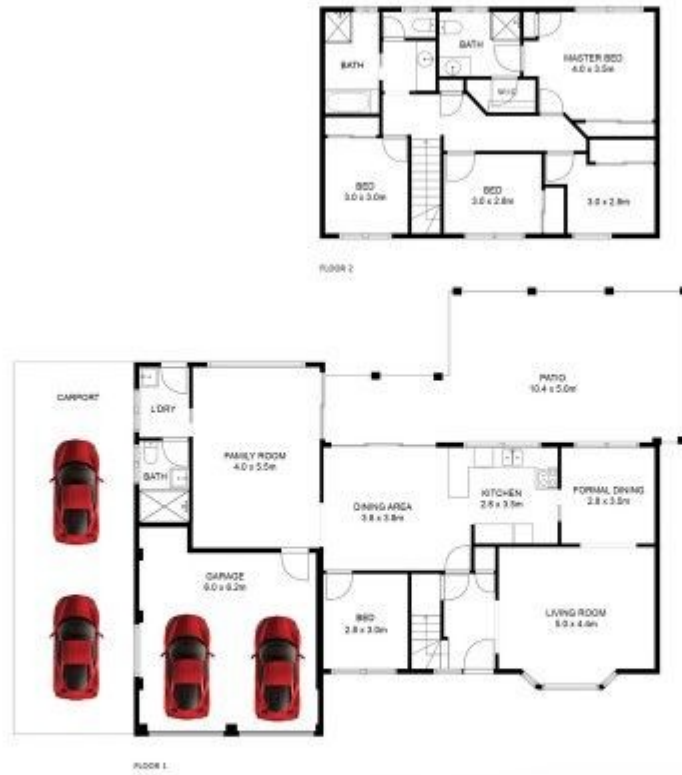

Disclaimer: Please note this floor plan is for marketing purposes and is to be used as a guide only. All dimensions are estimates only and may not be exact measurements.