



SOLD

MOVE-IN-READY TOWNHOUSE IN A THRIVING CORRIDOR – IDEAL FOR LIVING OR INVESTING, WITH STRONG RENTAL RETURNS AND FUTURE CAPITAL GROWTH POTENTIAL.

10/698-700 Kingston Road, Loganlea

3 | 2 | 1 Garage + 1 Car Space | Courtyard | Gated Complex | Move-in Ready

Proudly owner-occupied and meticulously maintained, this move-in-ready 3-bedroom townhouse offers a seamless blend of modern living, comfort, and unbeatable convenience in the heart of Loganlea. Whether you're a first-home buyer, downsizer, or investor, this home ticks all the boxes.

Spacious Living with a Fresh Modern Feel

The open-plan layout is light-filled and inviting, featuring air conditioning, ceiling fans, and a modern kitchen fitted with a brand-new gas cooktop, dishwasher, and rangehood. Each of the three bedrooms includes built-in wardrobes, while the master features a private ensuite.

Outdoor Space You'll Love

Step out to your private, fully fenced courtyard with a covered patio—perfect for outdoor entertaining, relaxing, or kids and pets to play.

Secure Parking & Peace of Mind

The home includes a remote-control garage plus an additional car space, all within a gated complex equipped with security cameras.

Key Features:

- Owner-occupied, very well looked after, and move-in ready
- 3 spacious bedrooms with built-in wardrobes
- 2 bathrooms, including an ensuite to the master
- Air conditioning in the living and Master bedroom, with ceiling fans throughout.
- Modern kitchen with brand-new gas cooktop, dishwasher & rangehood
- Private courtyard with covered outdoor entertaining area
- Broadband internet ready
- Remote garage + extra carport (2 car parking)

3 BED | 2 BATH | 2 CAR

PRICE:
\$646,555

OPEN FOR INSPECTION:
N/A



Yogi Sharma
0415558800

yogi.sharma@atrealty.com.au
www.atrealty.com.au

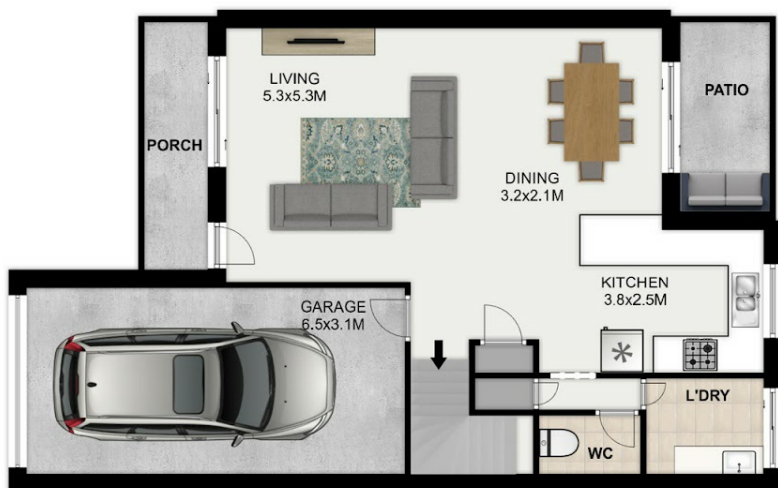

3 2 2

This floorplan is not to scale; measurements are indicative and in meters. Exterior elements are not in position. Plans should not be relied on. Interested parties should make and rely on their own enquiries. All other information provided has been collected from reliable sources but cannot be guaranteed for accuracy.

10/698 Kingston Road, **LOGANLEA**



Disclaimer: Please note this floor plan is for marketing purposes and is to be used as a guide only. All dimensions are estimates only and may not be exact measurements.

Yogi Sharma
0415558800
 yogi.sharma@atrealty.com.au
www.atrealty.com.au

