



SOLD

SUNSET VIEWS FOREVER - LEVEL 3 – WITH LIFT ACCESS

Perfectly positioned on the edge of Darwin's CBD, 13/7 Brewery Place, Woolner offers a lifestyle that blends comfort, convenience, and breathtaking views. From the moment you step inside, you are greeted with a sense of space and light, complemented by cooling breezes and a stunning backdrop of the city skyline and harbour.

This spacious three-bedroom apartment showcases a contemporary open-plan layout designed to make the most of our tropical climate. The gourmet kitchen, expansive living area, and seamless flow to a private entertainer's balcony create a home that is both practical and inspiring. Whether it's a quiet night in or a sunset gathering with friends, every moment here feels special.

Property Highlights:

- Highly desired city fringe location with easy access to Darwin CBD
- Level 3 with picturesque city and harbour views
- Open-plan living with a seamless indoor-outdoor connection
- Large private balcony perfect for entertaining or relaxing at sunset
- Gourmet kitchen with expansive bench space, breakfast bar, and ample storage
- Spacious bedrooms with built-in robes, main with ensuite
- Tiled and air-conditioned throughout for year-round comfort
- Two dedicated car parks plus storeroom
- Lift access, excellent privacy, and security
- Just minutes to Parap Markets, schools, East Point foreshore, and more
- Pets are allowed on application

Offering low-maintenance living in a premium location, this apartment is the perfect choice for those seeking a stylish home or a savvy investment.

Additional Information:

- Year Built: 2003
- Status: Vacant possession – ready for you to move in immediately.
- Body Corp Manager: Whittles Body Corporate
- BC ADMIN Fund (approx.): \$1,235 per quarter

3 BED | 2 BATH | 2 CAR

PRICE:
\$475,000

OPEN FOR INSPECTION:
N/A



Nicole Wheeler
0417508800
nicolewheeler@atrealty.com.au
www.atrealty.com.au

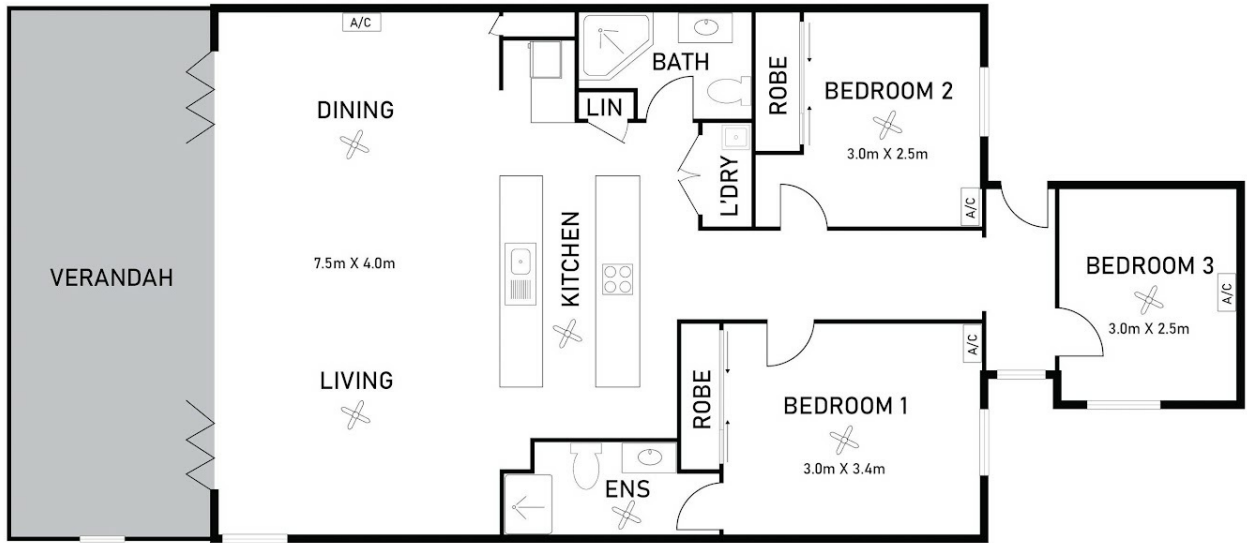

Scale in meters. Indicative only. Dimensions are approximately. All information contained here in is gathered from source we believe to be reliable. However we cannot guarantee its accuracy and interested persons should rely on their own enquiries

13/7 Brewrey Place Woolner



Disclaimer: Please note this floor plan is for marketing purposes and is to be used as a guide only. All dimensions are estimates only and may not be exact measurements.