

SOLD

MODERN 3BR FAMILY HAVEN IN CRANBOURNE WEST

Step into this beautifully designed 3-bedroom, 2-bathroom family home at 7 Breamlea Way, where modern comfort meets thoughtful functionality in the heart of Cranbourne West. This impressive residence offers the perfect blend of indoor luxury and outdoor entertaining, making it an ideal sanctuary for growing families seeking space, style, and convenience.

The heart of this home features two generous living areas that flow seamlessly throughout, complemented by elegant floorboards that add warmth and character to every room. The well-appointed kitchen comes complete with a dishwasher and built-in appliances, making meal preparation a pleasure rather than a chore. A dedicated study provides the perfect work-from-home solution or quiet retreat for children's homework.

Comfort is assured year-round with split system air conditioning and heating which provides additional warmth during cooler months. The master bedroom boasts an ensuite and built-in wardrobes, with all bedrooms featuring built-in storage solutions that maximise space and minimise clutter.

- Solar panels and solar hot water system for eco-friendly living and reduced energy costs
- Remote garage with secure parking for two vehicles
- Fully fenced 503sqm block providing privacy and security
- Entertainment area and outdoor deck perfect for hosting gatherings

The outdoor spaces truly shine with multiple entertaining areas designed for year-round enjoyment. The covered deck extends your living space outdoors, while the entertainment area provides the perfect setting for barbecues and family celebrations. The fully fenced yard offers a safe haven for children and pets to play freely.

Cranbourne West has experienced tremendous growth since the 1990s and offers everything a modern family needs. The nearby Sandhurst Centre on Duff Street and Monahans Road provides convenient shopping with Woolworths and specialty stores just minutes away. Families will appreciate the excellent educational options including Quarters Primary School, Barton Primary School, and Cranbourne West Secondary College, with the prestigious St Peters College also within the suburb.

3 BED | 2 BATH | 2 CAR

PRICE:
\$745,000

OPEN FOR INSPECTION:
N/A



Manpreet Sandhu
0415252061

manpreet@fatehrealstate.com.au
Fateh Real Estate



Floor Plan

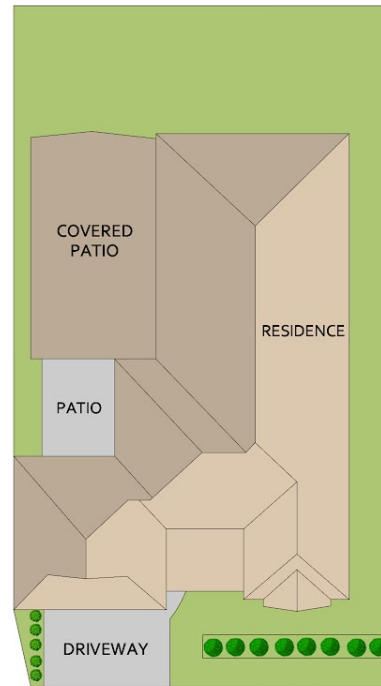

Site Plan

The floor plan is not to scale. Areas and dimensions are approximate and therefore plan should only be used for illustrative purposes

Disclaimer: Please note this floor plan is for marketing purposes and is to be used as a guide only. All dimensions are estimates only and may not be exact measurements.